

CHAIN SOLUTIONS

FOR THE WOOD INDUSTRY

SAWMILLS - PLANING - GRINDING - CLT - BSH
CHIP BOARD - MDF - OSB
BIOMASS - THERMAL HEATING

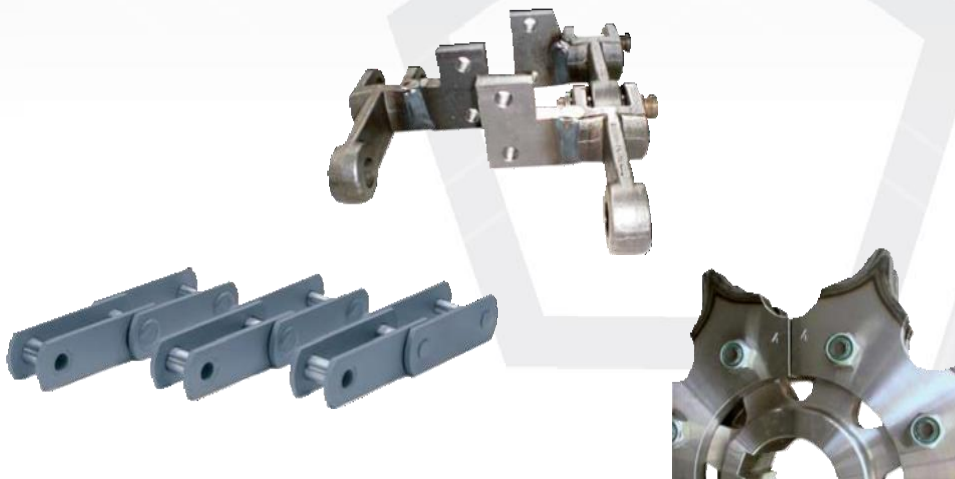

We make your chain applications profitable

Content

- 3 Who is FB Ketten
- 4-5 Design of FB conveyor chains
- 6-7 Dimensions of FB conveyor chains
- 8 **New:** FB Profile chain – **FB Green Chain**
- 9 FB hollowpin conveyor chains
- 10 Customized attachments
- 11 Sprockets for conveyor chains
- 12-14 Conveyor chains for log transport
- 15-19 FB scraper chains
- 20 **inno** scrapers
- 21-22 FB timber transport chains
- 23 Rollerchains DIN8187 – ISO606 – B-Series
- 24 Rollerchains DIN8188 – ISO606 – ANSI
- 25 Rollerchains straight sideplates, double pitch rollerchains
- 26 Attachments for rollerchains
- 27 Sharp top rollerchains for butt flare reducers
- 28-29 Sharp top rollerchains for canters, bandsaws and circular saws
- 30 Sharp top rollerchains for edgers
- 31 Sharp top rollerchains for transfer decks
- 32 Rubber top roller chains, chains with plastic components which protect our goods
- 33 Rollerchains for log transport
- 34 FB leafchains - design
- 35 Leafchains light series LL (EL) – DIN8152-1 (ISO4347)
- 36 Leafchains heavy series LH (BL) – DIN8152-3
- 37 Leafchains AL ANSI B29.8
- 38 Drop forged link chains
- 39 Sprockets and rollers for drop forged link chains

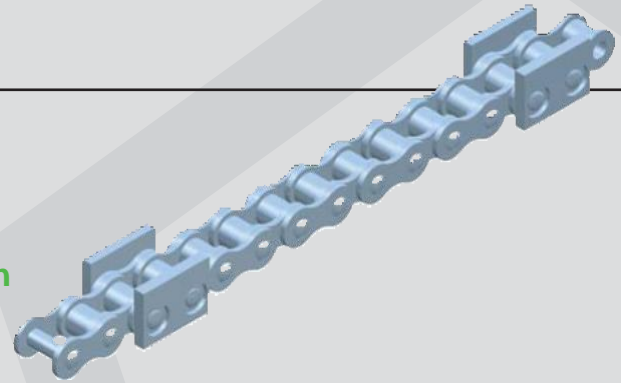

*) the footmark / note "in stock" means prior to sales We reserve the right to change the design, materials, construction or dimensions.

© FB Ketten Handelsgesellschaft mbH, A 6330 Kufstein
www.fb-ketten.at

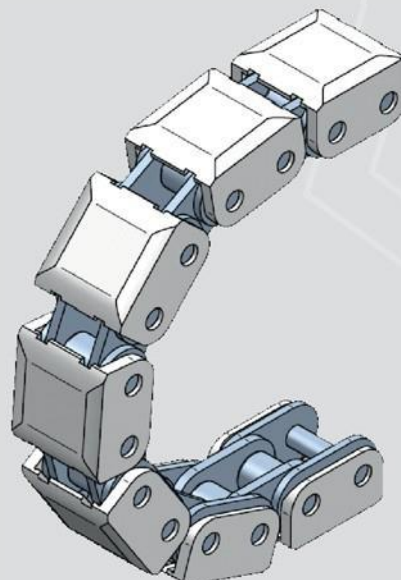

More than 110 years of experience

We started to produce conveyor chains, sharp top chains, roller chains and leaf chains in 1908 in Eskilstuna (Sweden). FB Ketten is part of the Swedish Adtech-group.

FB is technology and market leader in European sawmills and knows most of the chain-applications by heart. We produce chains according to international standards and are very strong in customized chains according to drawings or samples.

We do not only replace chains but offer to **optimize existing chain solutions** and make them work more profitable. We call this **FB-retroFIT**.

Our goal is to increase conveyor up-time, profitability and the operational security by through longer lifetime of chains, sprockets and chain rails.

In Austria, Germany, Sweden, Finland and UK we stock conveyor chains according to DIN8165 and DIN8167 (ISO1977), roller chains ISO606 (DIN8187, DIN8188), sharp top chains, roller chains with plastic attachments or rubber top, leaf chains and many customized chains which are very common in wood & wood processing, biomass power plants and chip board factories.

Experienced sales technicians welcome you and prepare offers that meet your technical and economical requirements.

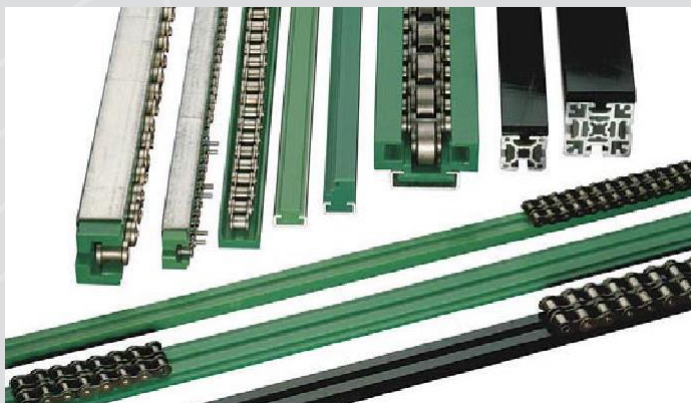

We help you to increase your profit

In Finland we produce our welded conveyor chains with welded pins and bushes. Our welded chains from FB Ketju are the strongest in the world. They offer highest fatigue strength, breaking loads and operational safety.



These high values can be reached by using high quality steels from Scandinavia which are good for welding.

Our chain design has over the years been developed in close cooperation with leading OEM, end users and Universities in Finland. The heat treatments of chain components are optimized to meet the demands of heavy applications in the forest industry.

Welding process and welding robs are continuously developed by our own welding specialists to meet the growing requirements of our demanding customers. Our customers should not expect less than the best from us.

The request to reach the longest possible lifetime, high machine up-time, lowest possible maintenance and repair costs – all in all lowest Total Cost of Ownership (TCO) - push us to be any day better than yesterday.



Pins



FB conveyor chain pins are produced from induction hardened MnCr-steels or hardened stainless steel (e.g. for conveying wet chips, bark or similar).

Standard for FB pins is round riveting, 4-point riveting or welding. On demand we lock the pins also by, S-pins, locking rings or other locking-types. We have several production possibilities.

FB standard chain pins are induction hardened on the bearing surface. Additional through hardening is our process if increased fatigue and breaking strengths is needed.

Pins are locked against rotation by precisely machined keyways, flats or rob-welding the pin to the outer link plates and assembled by strong press fit.

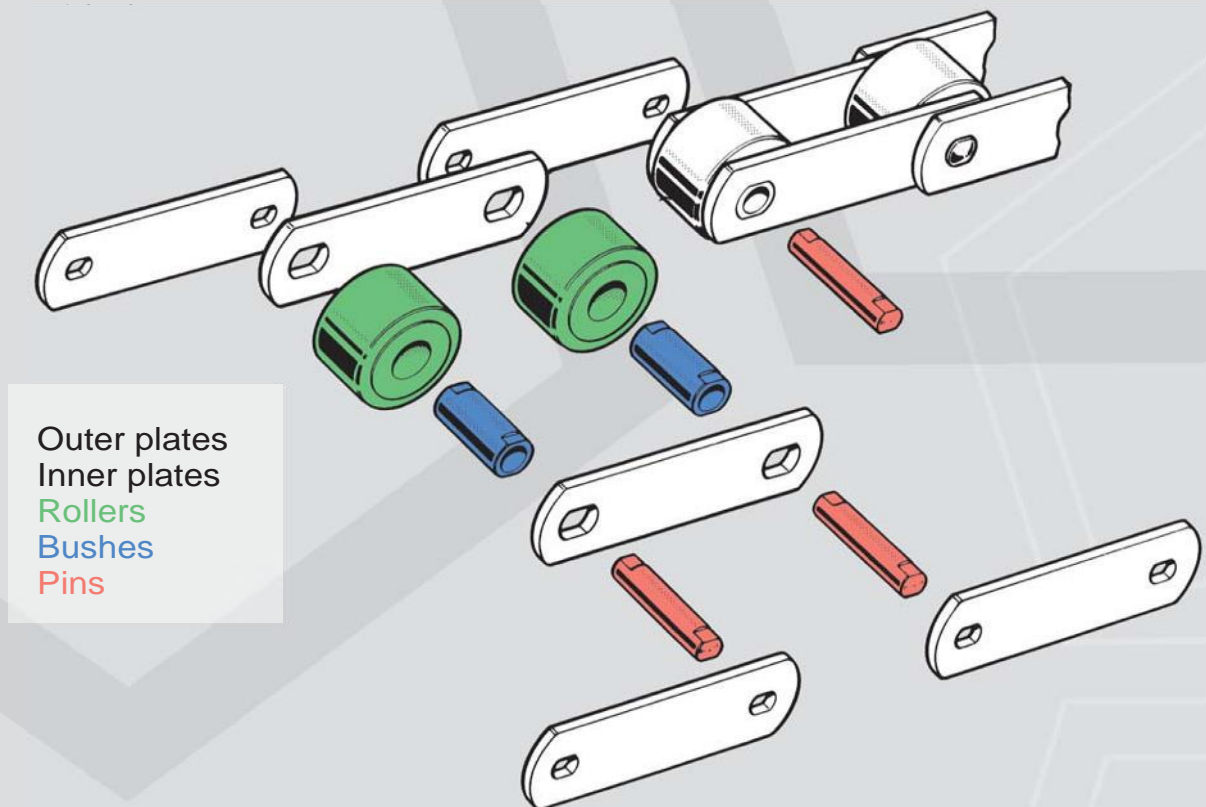

Outer plates
Inner plates
Rollers
Bushes
Pins

Bushes



FB conveyor chain bushes are produced from cold-drawn tube and locked against rotation by machined keyways or flats.

Our standard material is Ck15 case hardened, but we use also hardened MnCr-steels or hardened stainless steel.

The bushes are either assembled with a strong press fit or additional rob-welded from the outer side of the inner link plates.

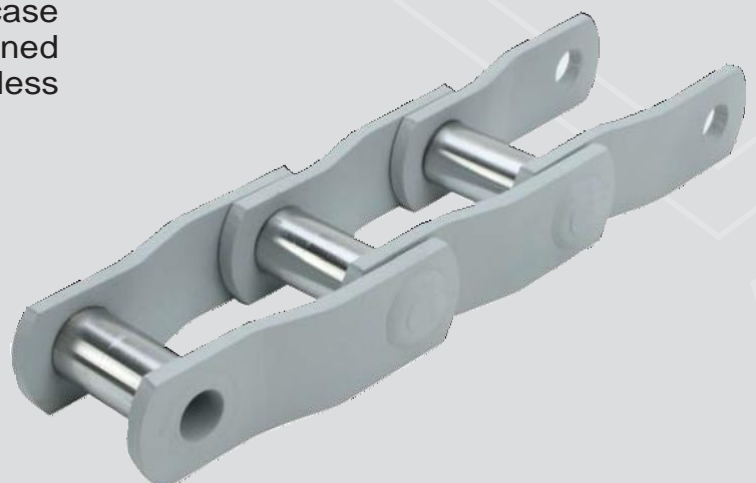

Rollers

FB conveyor chain rollers are made from Ck15 case hardened steel, optional from MnCr-steel or hardened stainless steel.

30-50 % higher fatigue strength by welded pins & bushes

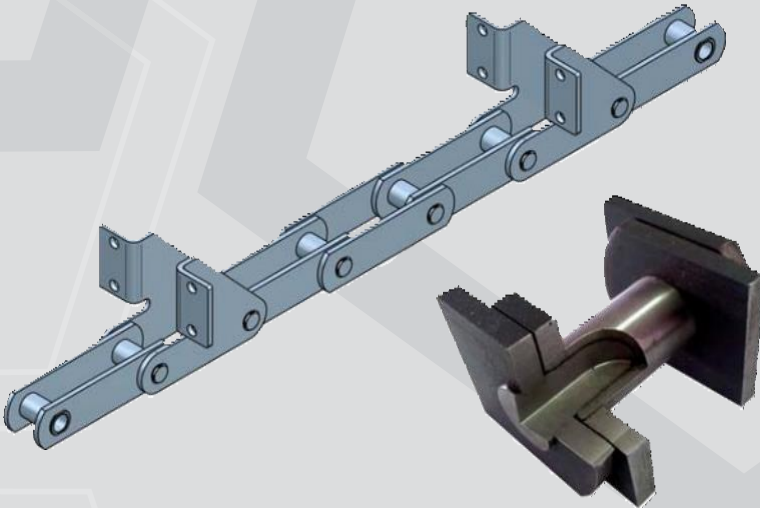
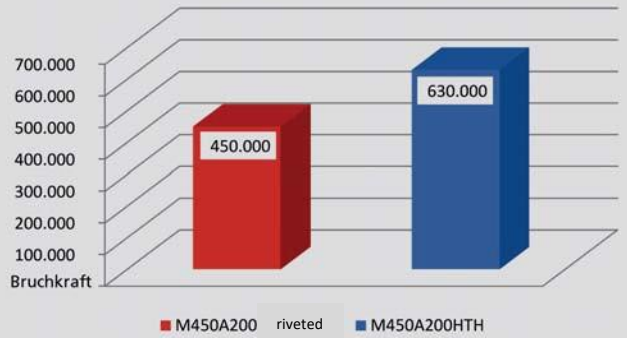
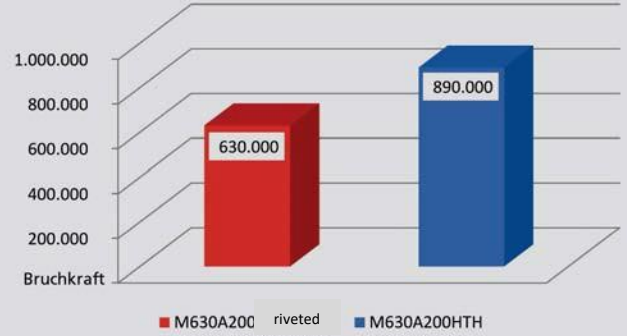

Linkplates (sideplates)

FB standard is S355-J2 (ST52-3), FB1000 or stainless steel.

Reduced wear and higher fatigue strength are achieved by through hardening.

Precise punching is the process to achieve very exact linkplate-bores and a strong pressfit.

This guarantees the even and durable contact between the round components and the link plates which results in a strong chain and long lifetime.

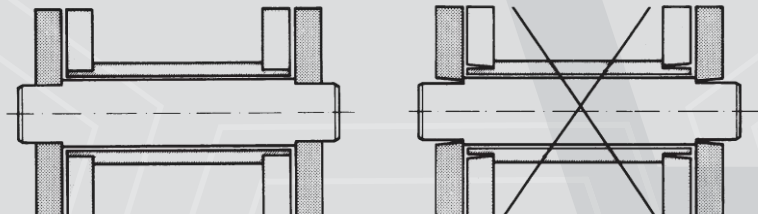

FB conveyor chain dimensions

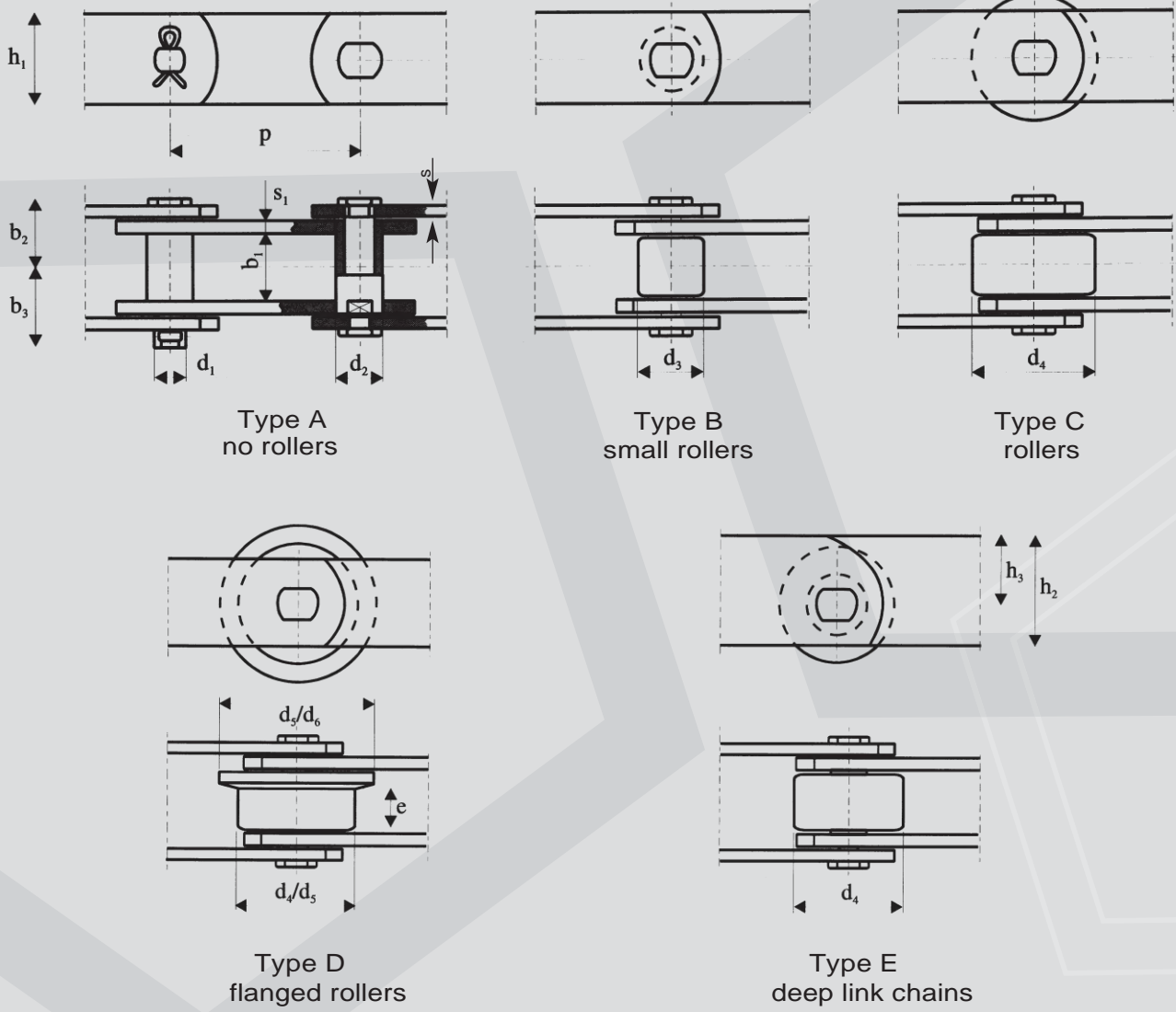

DIN8167, M-Serie(s), ISO1977

DIN-Nr. ISO No.	Breaking Load kN min.	Allowed Load N	Pitch mm	Inner Width b1 mm	Pin d1 mm	Bush d2 mm	Roller Type B d3 mm	Roller Type C d4 mm	Roller Type D		b2 mm	b3 mm	Sideplates			
									d5 mm	e mm			s/s1 mm	h1 mm	h2 mm	h3 mm
M 40	40	5.700	63 80 100 125	20	8,5	12,5	18	36	42	13,5	21	24	4	25	35	22,5
M 56	56	8.000	63 80 100 125	24	10	15	21	42	50	17	24	27	4	30	45	25
M 80	80	11.400	80 100 125 160	28	12	18	25	50	60	20	29	33	5	35	50	32,5
M112	112	16.000	80 100 125 160	32	15	21	30	60	70	22	33	38	6	40	60	40
M160	160	22.800	100 125 160 200	37	18	25	36	70	85	25,5	38	43	7	50	70	45
M224	224	32.000	100 125 160 200	43	21	30	42	85	100	30	44	49	8	60	90	60
M315	315	45.000	160 200 250 315	48	25	36	50	100	120	33	51	58	10	70	100	65
M450	450	64.000	200 250 315 400	56	30	42	60	120	140	37	60	66	12	80	120	80
M630	630	90.000	250 315 400 500	66	36	50	70	140	170	45	69	78	14	100		
M900	900	128.000	250 315 400 500	78	44	60	85	170	210	52	79	89	16	120		

DIN8165, FV-Serie(s)

DIN-Nr. ISO No.	Breaking Load kN min.	Allowed Load N	Pitch mm	Inner Width b1 mm	Pin d1 mm	Bush d2 mm	Roller Type B d3 mm	Roller Type C d4 mm	Roller Type D		b2 mm	b3 mm	Sideplates			
									d5 mm	d6 mm			s/s1 mm	h1 mm	h2 mm	h3 mm
(FV 40)	40	6.700	40 50 63 80 100	18	10	15	20	32	40	48	18,5	22	4	25	35	22
FV 40	40	6.700	40 50 63 80 100	18	10	15	20	32	40	48	18,5	22	3	26	35	22
FV 63	63	10.500	63 80 100 125	22	12	18	26	40	50	60	23	27,5	4	30	40	25
FV 90	90	15.000	63 80 100 125	25	14	20	30	48	63	73	26,5	31	5	35	45	27,5
FV112	112	18.700	63 80 100 125 160	30	16	22	32	55	72	87	31,5	36	6	40	50	30
FV140	140	23.400	100 125 160 200	35	18	26	36	60	80	95	34	40	6	45	60	37,5
FV180	180	30.000	100 125 160 200	45	20	30	42	70	100	120	43	50	8	50	70	45
FV250	250	41.700	125 160 200 250	55	26	36	50	80	125	145	49	57	8	60	80	50
FV315	315	52.500	160 200 250 315	65	30	42	60	90	140	170	58,5	66,5	10	70	90	55
FV400	400	66.700	160 200 250 315	70	32	44	60	100	150	185	65,5	75,5	12	70	90	55
FV500	500	83.400	160 200 250 315	80	36	50	70	110	160	195	70,5	80,5	12	80	100	60
FV630	630	105.000	200 250 315 400	90	42	56	80	120	170	210	76,5	86,5	12	100	120	70

FB Special Chain for Timber Transport – SR500 – full radius link plates

(FV90B)	170	28.300	50 100	25,4	14,63	18,7	25,4				23,5	34,2	5	40	R20	
---------	-----	--------	--------	------	-------	------	------	--	--	--	------	------	---	----	-----	--

SMS1698 Rollen auf Wunsch gehärtet. Rollers hardened upon request.

DIN-Nr. ISO No.	Breaking Load kN min.	Allowed Load N	Pitch mm	Inner Width b1 mm	Pin d1 mm	Bush d2 mm	Roller Type C d3 mm	2 x b2	b3 mm	Sideplates				Outer Plates	
										h1 mm	h2 mm	h3 mm	s1 mm	normal	heavy
3,5	35	5.800	50 63 80 100	18	10	15	32	49	22	25	35	22,5	4	4	6
5,5	55	9.160	50 63 80 100	22	12	18	40	54	27,5	30	40	25	5	4	6
8,5	85	14.100	63 80 100 150	25	14	20	50	65	31	35	50	32,5	6	5	8
12,5	125	20.800	100 150 200	35	18	26	60	81	36	40	60	40	8	6	8
18	180	30.000	100 150 200 250	45	20	30	70	96	40	50	78	45	8	6	10
24	240	40.000	100 150 200 250	55	26	36	80	116	50	60	80	50	10	8	12
30	300	50.000	150 200 250	65	30	42	90	128	57	70	90	55	10	8	12
40	400	66.600	150 200 250	80	36	50	110	148	66,5	80	110	70	10	12	12
65	650	108.300	150 200 250	80	36	50	110	158	75,5	90	120	75	12	15	15

Other dimensions, e.g. inner width, pitch, sideplate dimensions, bearing diameters upon request.

The FB Profile chain was designed in close cooperation with OEM and end users in the pulp & paper industry and our partners in the steel industry.

Reduced total cost of ownership

The FB profile chain is lighter and stronger than any other conveyor chain which achieves a breaking load of 500.000 N.

The **light-weight-design** reduces the energy cost, the **bigger bearing surface** results in reduced wear. Remarkable reduction of cost of ownership is achieved when FB profile chains will be combined with modern **INNO-scrapers**.

We call this the **FB green chain**.

Incomparable operational safety – strong against lateral shock load

Welded pins and bushes are very important to make FB profile chain and FB green chain are very strong against lateral shock which can be the effect when goods are blocking the chain or when chain-pull is uneven.

Protected pin ends

Users profit from the clever light-weight-design of the profile links. An extra benefit is that the pin ends are not extending the link plates protected against wear.

Wear resistant sideplates

OVAKO steel is producing for us the customized flat material FB1000 which we use in our profile chains and green chains.

The biggest benefit is the low carbon content of 0,25-0,30% although the hardness is 240 HB for standard applications.

In applications where a better wear resistance is needed we can harden FB1000 to 350 HB and it will be still **very good for welding**.



Chain type	Pitch	Inner width	Pin Ø	Bush Ø Type A	Roller Ø Type B	sideplates	width	Weight Type A	Weight Type B
FB500	160 mm 200 mm	65 mm	26 mm	40 mm	55 mm	70x12 mm	116 mm	18,9 kg/m 17,3 kg/m	22,4 kg/m 20,1 kg/m
Breaking Load	500.000 N min.		FB steel through hardened + induction hardened	Ck15 case hardened	Ck15 case hardened	FB1000 240 HB or FB1000TH 350 HB			

Other roller dimensions and customized attachments on demand!

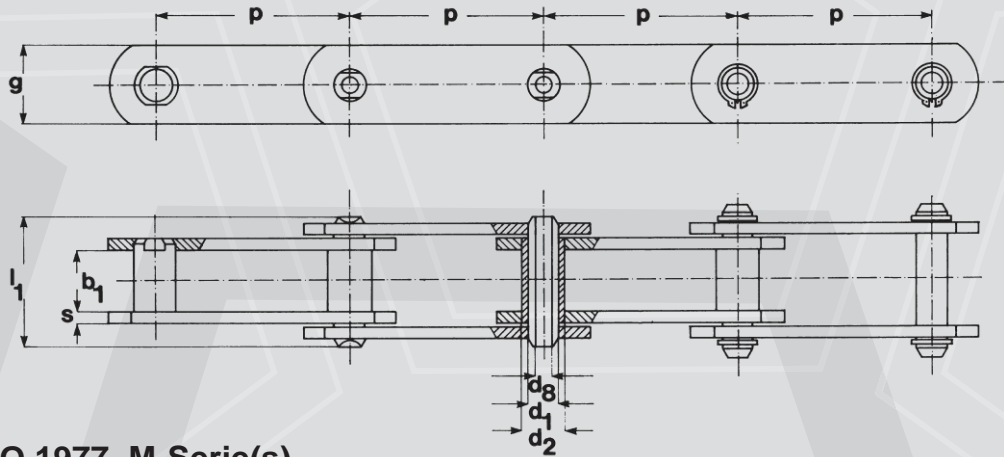

DIN8168, ISO 1977, M-Serie(s)

DIN-Nr. ISO No.	Breaking Load kN min.	Allowed Load N	Pitch mm	Inner Width b1 mm	Pin d8 /d1 mm	Bush d2 mm	Roller Type B d3 mm	Roller Type C d4 mm	Roller Type D d4/d5 mm	l1 mm	Sideplates			
											s mm	g mm	h2 mm	h3 mm
(MC28)	28	4.000	63 80 100 125 160	20	8,5/12,5	18	25	36	36/45	42	4	25	35	22,5
MC28	28	4.000	63 80 100 125 160	20	8,2/13	17,5	25	36	36/45	40	3,5	25	35	22,5
(MC56)	56	8.000	80 100 125 160 200 250	22	10,1/15	21	30	50	50/60	49	5	35	50	32,5
MC56	56	8.000	80 100 125 160 200 250	24	10,2/15,5	21	30	50	50/60	47	4	35	50	32,5
(MC112)	112	16.000	80 100 125 160 200 250	30	14,1/20	30	42	70	70/85	66	7	50	70	45
MC112	112	16.000	100 125 160 200 250 315	32	14,3/22	29	42	70	70/85	64	6	50	70	45
(MC224)	224	32.000	125 160 200 250 315	40	20,2/30	42	60	100	100/120	86	10	70	100	65
MC224	224	32.000	125 160 200 250 315	43	20,3/31	41	60	100	100/120	83	8	70	100	65

DIN8165, FV-Serie(s)

DIN-Nr. ISO No.	Breaking Load kN min.	Allowed Load N	Pitch mm	Inner Width b1 mm	Pin d8 /d1 mm	Bush d2 mm	Roller Type B d3 mm	Roller Type C d4 mm	Roller Type D d4/d5 mm	l1 mm	Sideplates			
											s mm	g mm	h2 mm	h3 mm
FVC63	46 / 75*	10.500	63 80 100 125 160	22	8,2/12	18	26	40	50/60	46	4	30	40	25
FVC90	73 / 90*	15.000	63 80 100 125 160 200 250	25	10,2/14	20,0	30	48	63/78	53	5	35	45	27,5
FVC112	90 / 132*	18.700	100 125 160 200 250	30	11,2/16	22	32	55	72/87	63	6	40	50	30
FVC140	110 / 170*	23.400	100 125 160 200 250	35	12,2/18	26	36	60	80/95	68	6	45	60	37,5
FVC180	145 / 190*	30.000	125 160 200 250 315	45	14,2/20	30	42	70	100/120	68	8	50	70	45
FVC250	215 / 300*	41.700	160 200 250 315	55	18,2/26	36	50	80	125/145	98	8	60	80	50

* Sideplates through hardened (hardened and tempered)

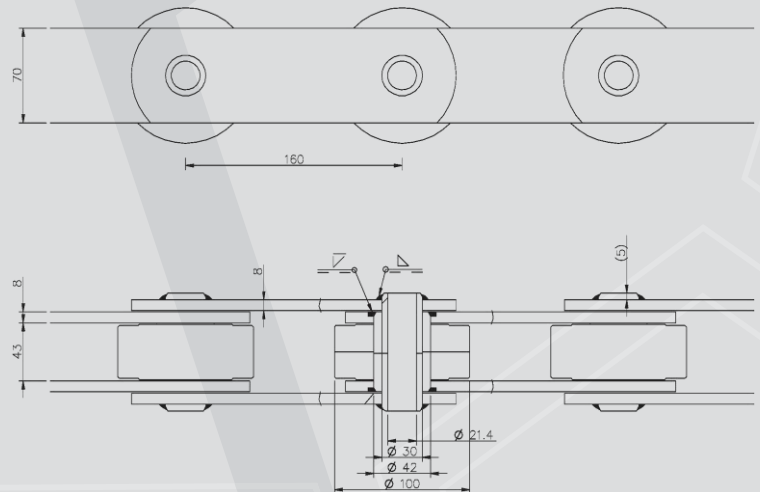

Other dimensions, e.g. inner width, pitch, sideplate dimensions, bearing diameters upon request.

Tailor made attachments

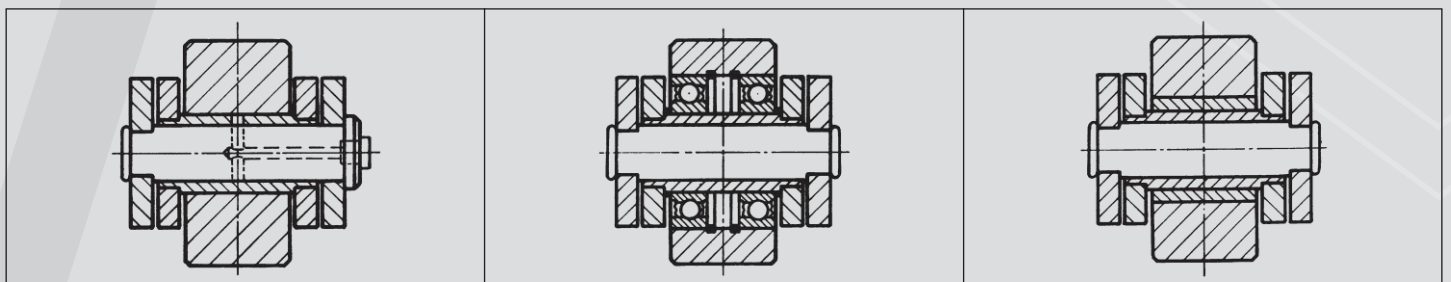
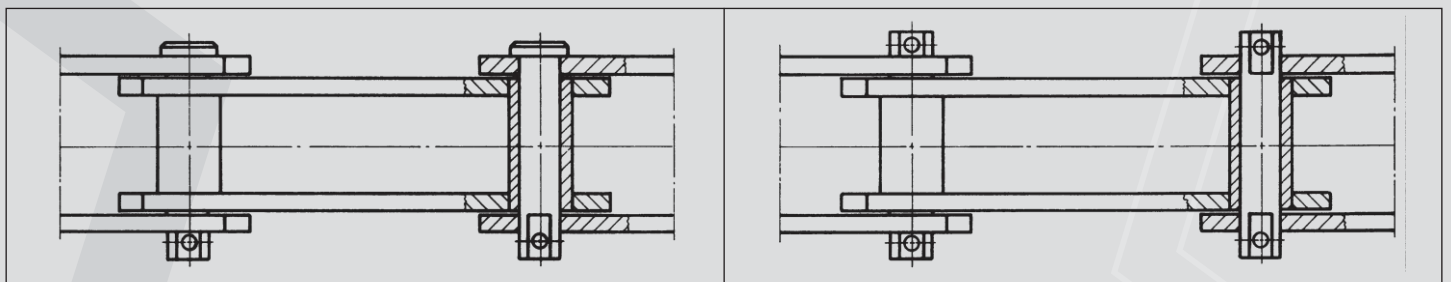
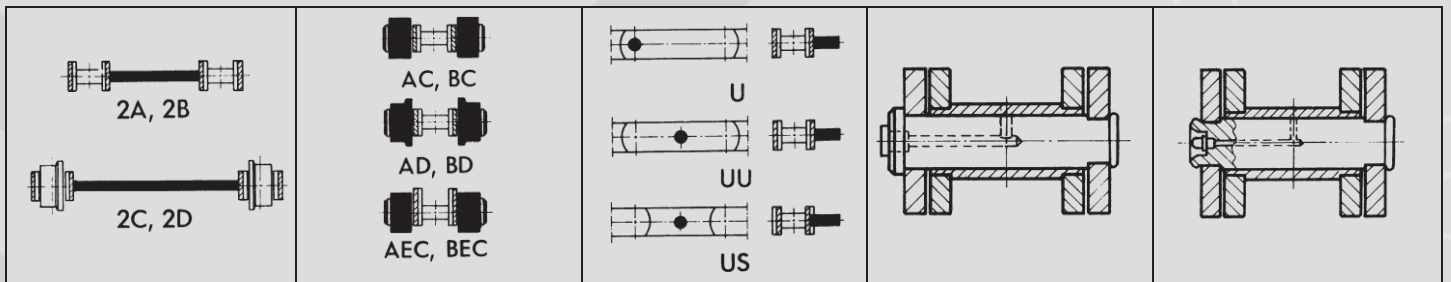
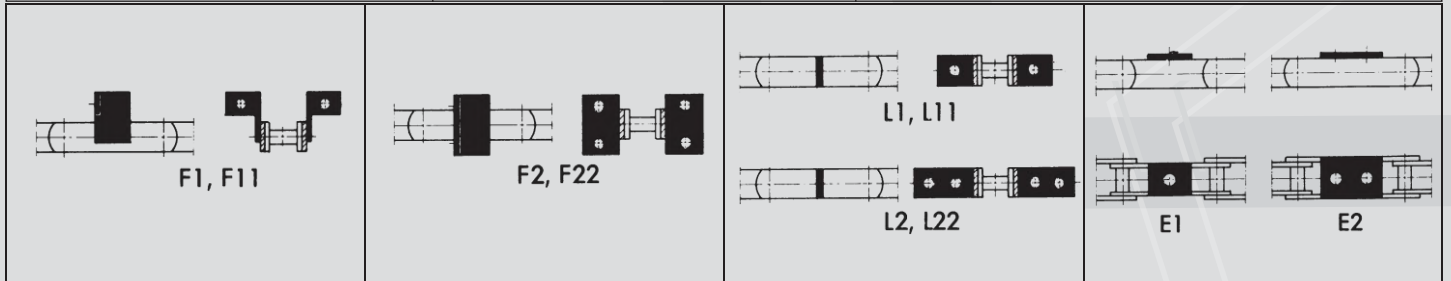
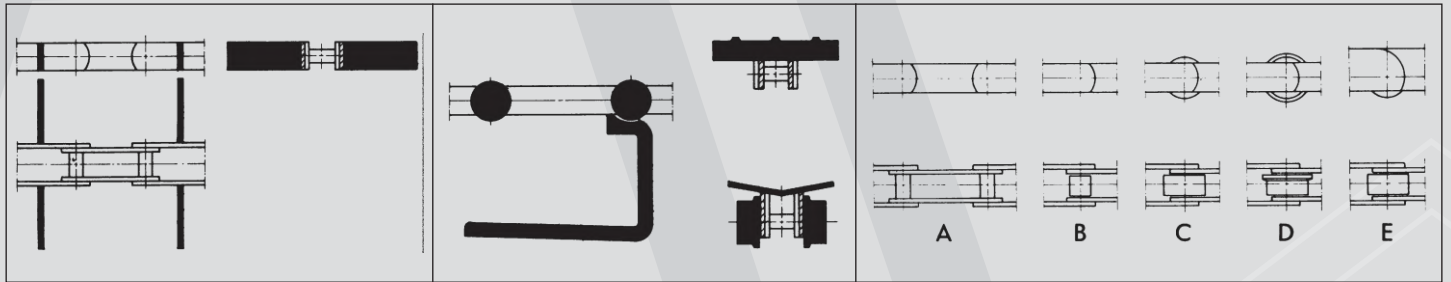
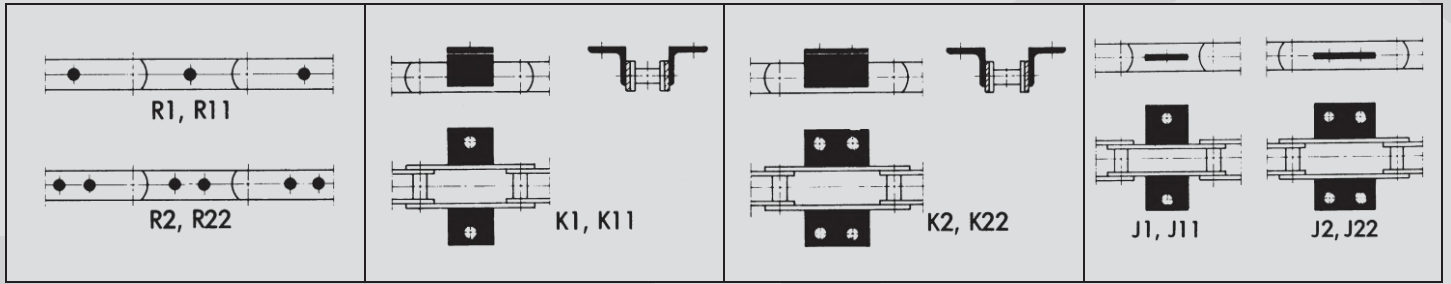

Standard tooth gap

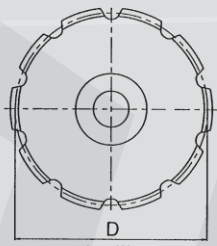

einteilig
Solid wheel
N

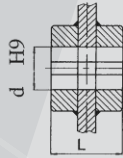

N 1
NN 1
Keyway
Keilnut

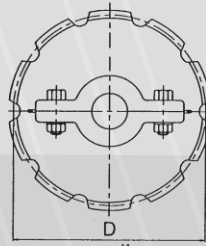

geteilt
Split wheel
NN

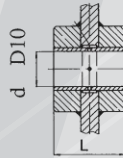

N 2
Selflubricating
bush
wartungsfreie Buchse

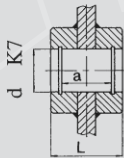

N 4
Ball bearing
design
Lagersitz

Extended tooth gap

may be turned for 180° = double lifetime

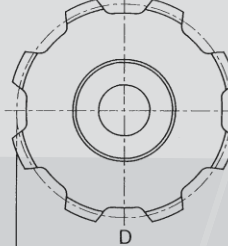

einteilig
Solid wheel
YN

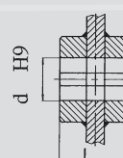

YN 1
XN 1
Keyway
Keilnut

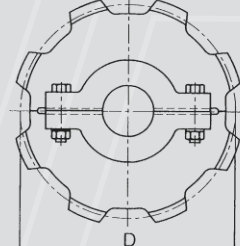

geteilt
Split wheel
XN

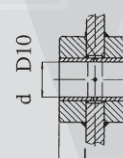

YN 2
Selflubricating
bush
wartungsfreie Buchse

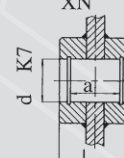

YN 4
Ball bearing
design
Lagersitz



Pitch Circle Ø (PCD) mm

P z	40	50	63	80	100	125	160	200	250	315	400	500
6	80,00	100,00	126,00	160,00	200,00	250,00	320,00	400,00	500,00	630,00	800,00	1000,00
7	92,19	115,24	145,20	184,38	230,48	288,10	368,76	460,96	576,20	726,01	921,92	1152,40
8	104,52	130,65	164,62	209,04	261,31	326,63	418,09	522,62	653,27	823,12	1045,24	1306,55
9	116,95	146,19	184,19	233,90	292,38	365,47	467,80	584,76	730,95	920,99	1169,52	1461,90
10	129,44	161,80	203,87	258,88	323,61	404,51	517,77	647,22	809,02	1019,37	1294,37	1618,05
11	141,98	177,47	223,61	283,96	354,95	443,68	567,92	709,90	887,37	1118,09	1419,80	
12	154,54	193,18	243,41	309,09	386,37	482,96	618,19	772,74	965,92	1217,06	1545,48	
13	167,14	208,93	263,25	334,28	417,86	522,32	668,57	835,72	1044,65	1316,25	1671,44	
14	179,76	224,70	283,12	359,52	449,40	561,75	719,04	898,80	1123,50	1415,61		
15	192,38	240,48	303,01	384,77	480,97	601,21	769,55	961,94	1202,42	1515,05		
16	205,03	256,29	322,92	410,06	512,58	640,72	820,12	1025,16	1281,45	1614,62		
17	217,68	272,11	342,85	435,37	544,22	680,27	870,75	1088,44	1360,55	1714,29		
18	230,35	287,94	362,80	460,70	575,88	719,85	921,40	1151,76	1439,70			
19	243,02	303,77	382,75	486,04	607,55	759,43	972,08	1215,10	1518,87			
20	255,70	319,62	402,72	511,40	639,25	799,06	1022,80	1278,50	1598,12			
21	268,38	335,47	422,69	536,76	670,95	838,68	1073,52	1341,90	1677,37			
22	281,06	351,33	442,68	562,13	702,67	878,33	1124,27	1405,34				
23	293,75	367,19	462,66	587,51	734,39	917,98	1175,02	1486,78				
24	306,45	383,06	482,66	612,90	766,13	957,66	1225,80	1532,26				
25	319,14	398,93	502,65	638,29	797,87	997,33	1276,59	1595,74				
26	331,84	414,81	522,66	663,69	829,62	1037,02	1327,39	1659,24				
27	344,55	430,69	542,66	689,10	861,38	1076,72	1378,20	1722,76				
28	357,25	446,57	562,67	714,51	893,14	1116,42	1492,02					
29	369,96	462,45	582,69	739,92	924,91	1156,13	1479,85					
30	382,67	478,34	602,70	765,34	956,68	1195,85	1530,68					

Log yard, log separator

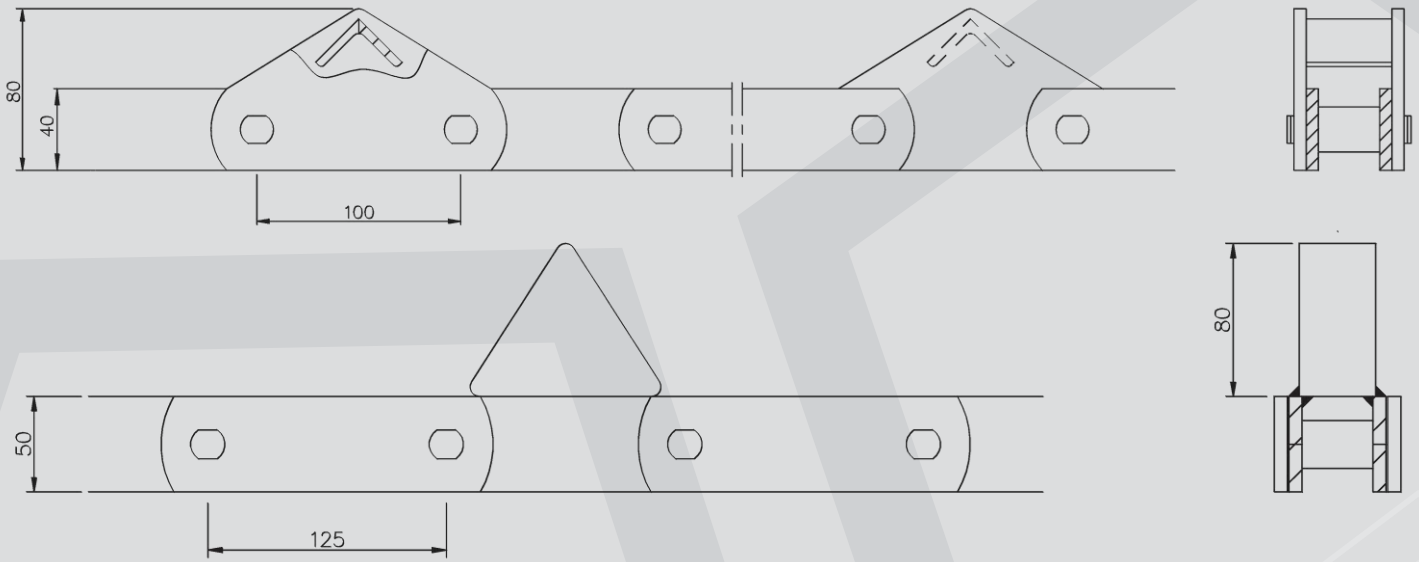

Log infeed chain, separator chain

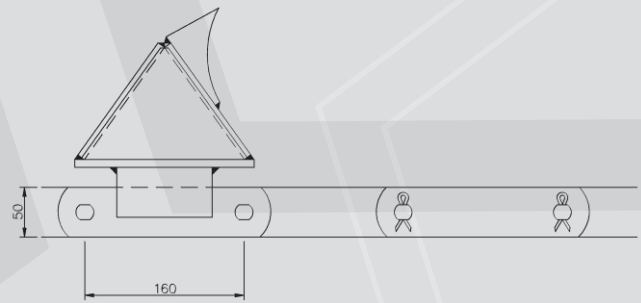

Log separator chain

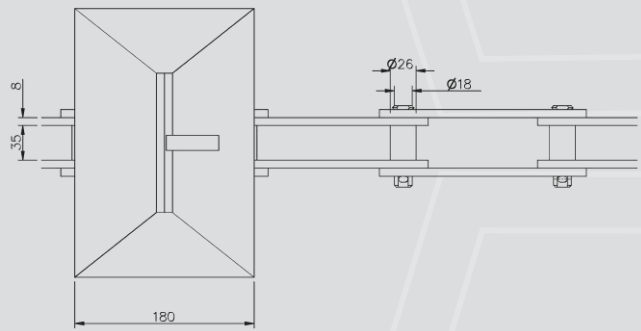

Curve conveyor

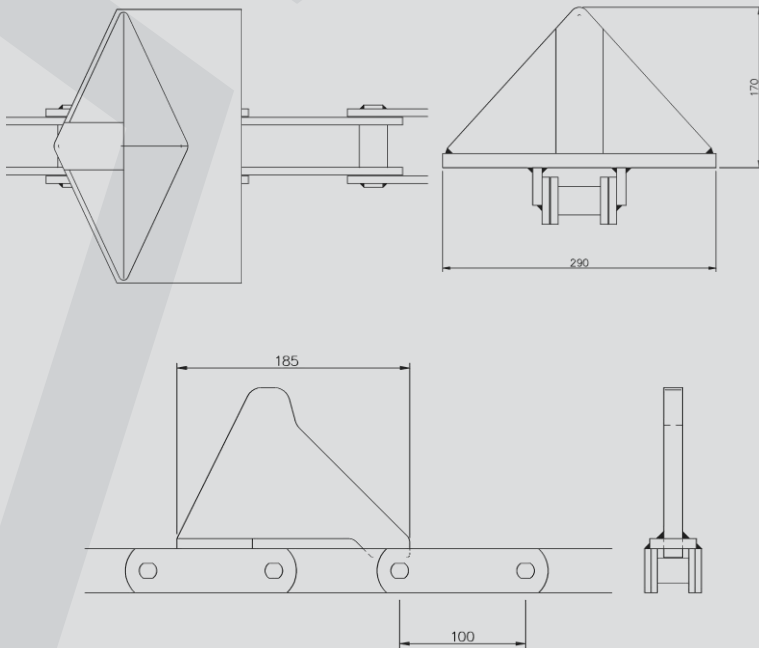

Log separator chain



Log separator

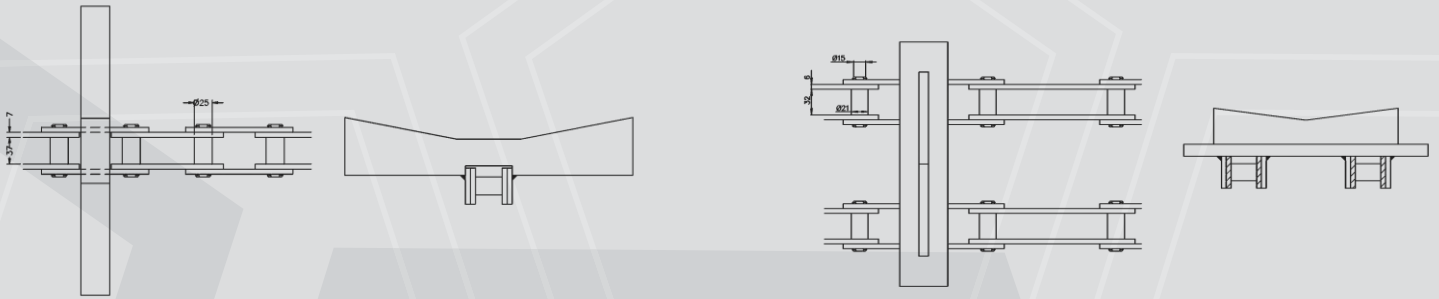

Infeed chains, outfeed chains

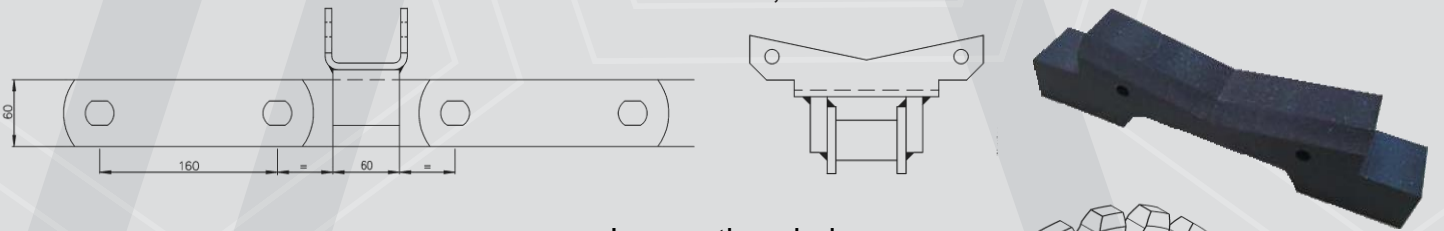

Log sorting chain

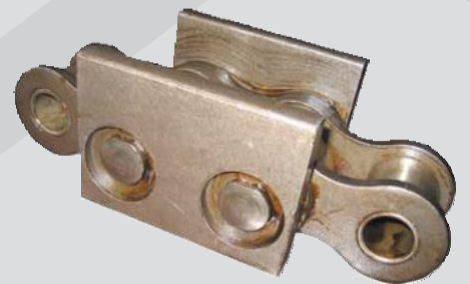
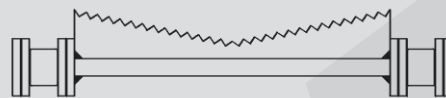
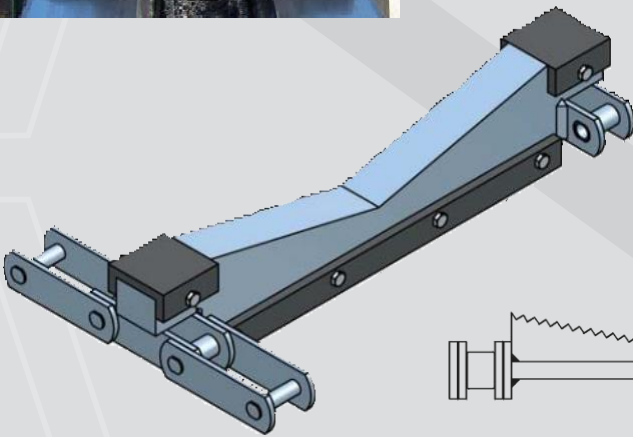
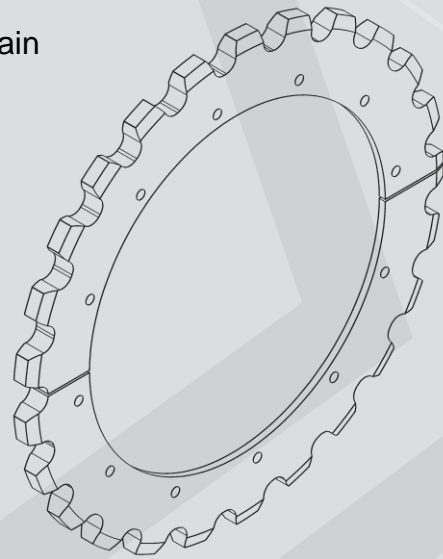

Measuring conveyor

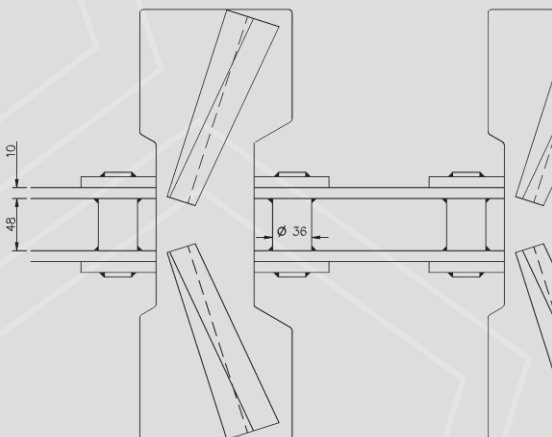

Debarker – Infeed Chain

Log transport

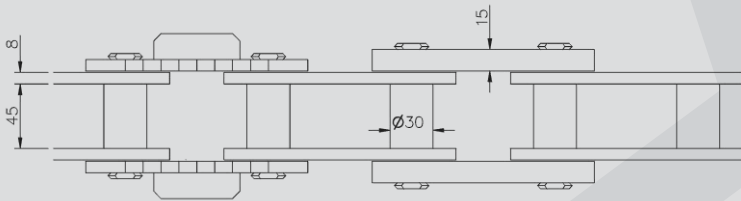
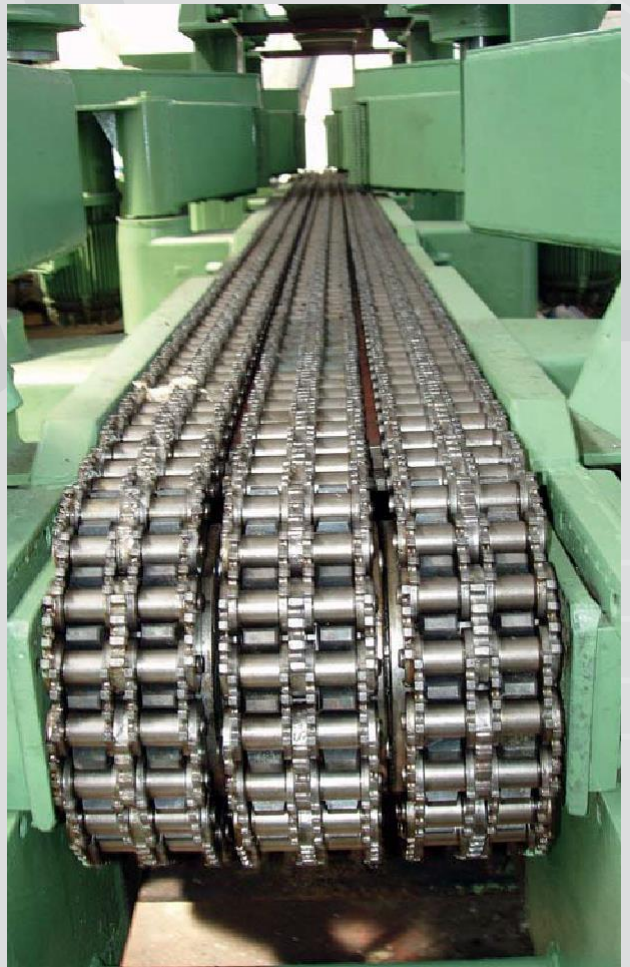
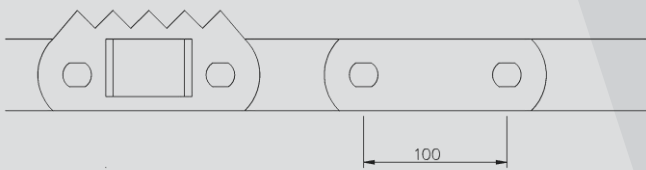
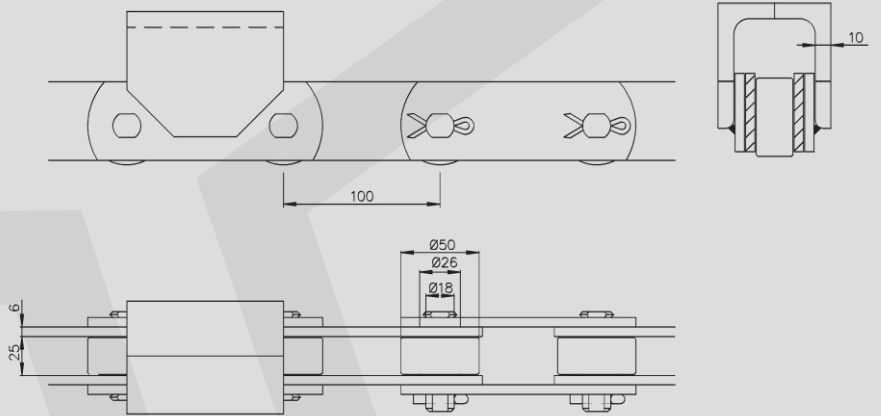

Center infeed chains

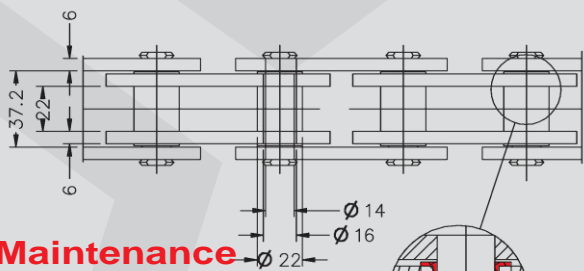
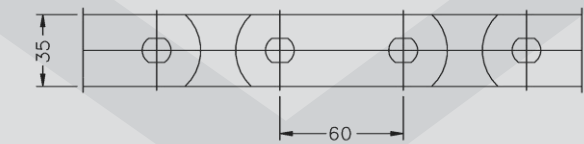

Maintenance free bush
(FV90A)60GFM-35x6
Outfeed chain

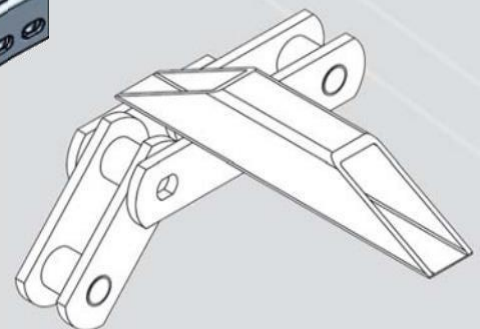
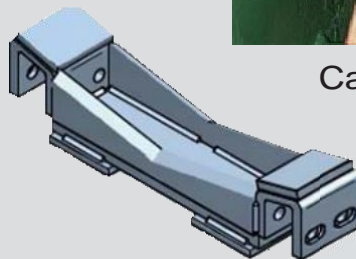
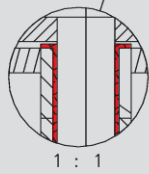

Plastic attachment for log transport chain (infeed / outfeed)

Illustration 1

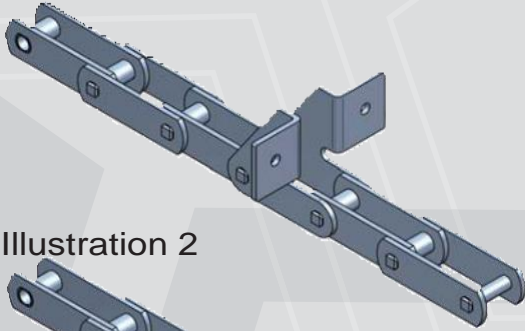

Illustration 2

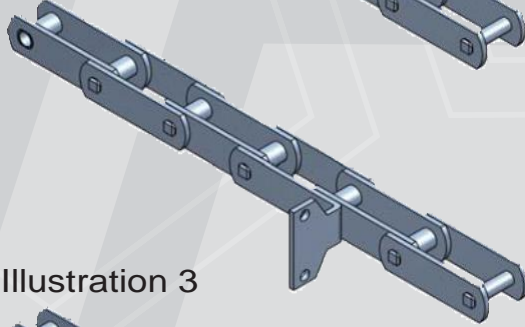

Illustration 3

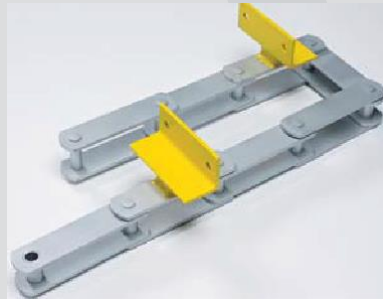
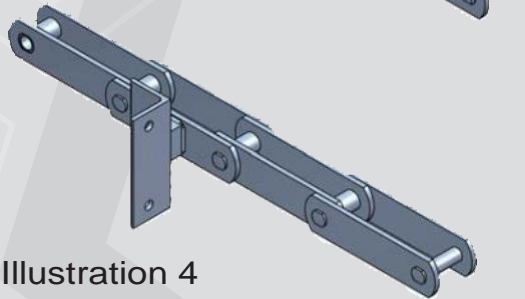

Illustration 4

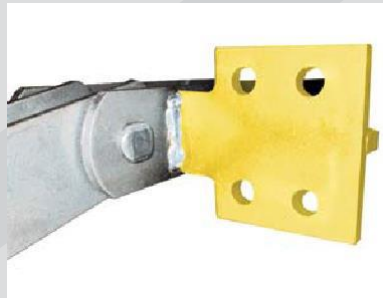
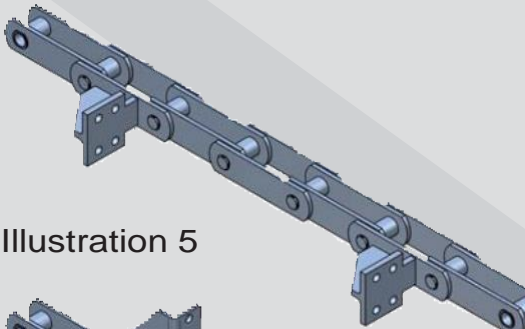
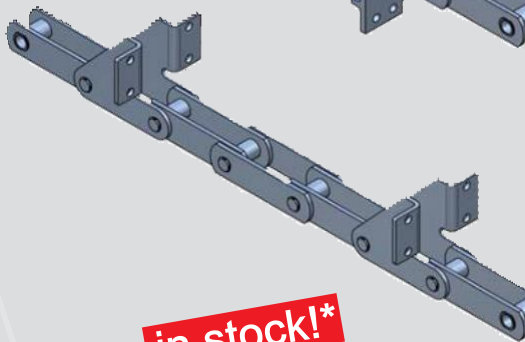

Illustration 5



Scraper chains

in stock!*

all dimensions in mm	p	Inner width b1	Pin Ø d1	Bush Ø d2	sideplates h1 x s	Illustration No.	Breaking load kN min.
(FV90)A100T/F11x400 or x600	100	25	14	20	40x6	1	140
M112A100T/F11x600	100	32	15	21	40x6	1	140
M112A100T/F2x400 or x600	100	32	15	21	40x6	2	140
FV140A125T/T4x500 or x1000	125	35	18	26	45x6	4	160
FV140A125T/F22x500	125	35	18	26	45x6	5	160
FV180A125T/T4x500 or x1000	125	45	20	30	50x8	4	205
M160A160FB/F2x640	160	37	18	25	50x7	2/3	185
FV180A160/T4x640	160	45	20	30	50x8	4	205
M224A160/T4x640	160	43	21	30	60x8	4	250

Other dimensions or design are produced will be produced upon individual drawings.
Scraper chain design with bigger clearance and corrected pitch in outer pitches.

FB Scraper chains

FV180A125T/T4x500, FV180A125T/T4x1000

(attachment pitch 500, 1.000 mm or tailor made) for double chain conveyors

in stock!*

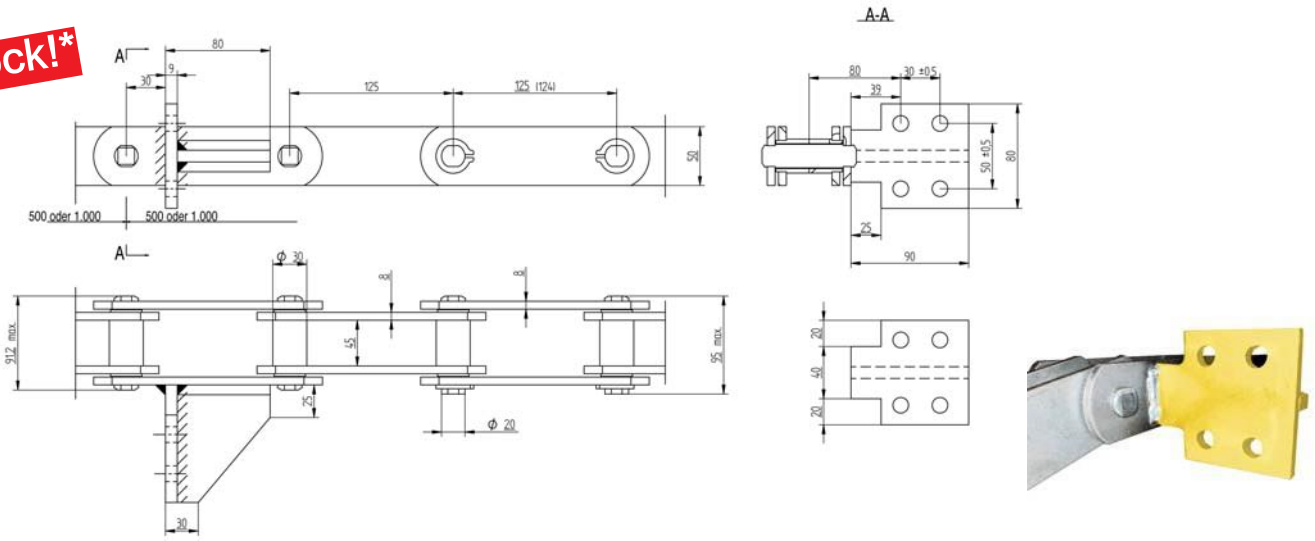

(FV140)C100-45x8/F2x600

(attachment pitch 640 mm or tailor made) for double chain conveyors

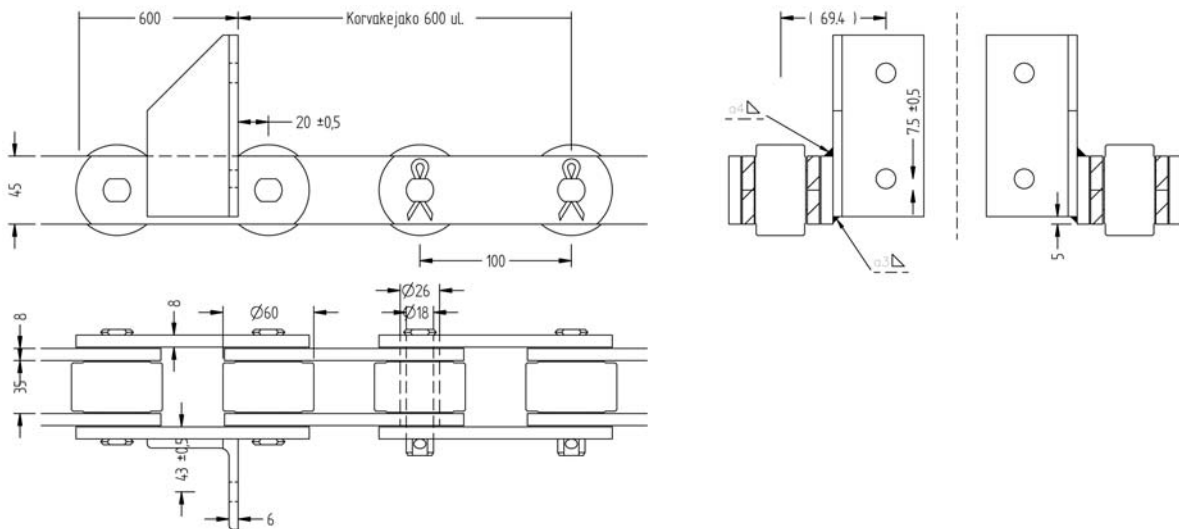

(FV180)C160V/(F4)x640

(attachment pitch 640 mm) for double chain conveyor

in stock!*

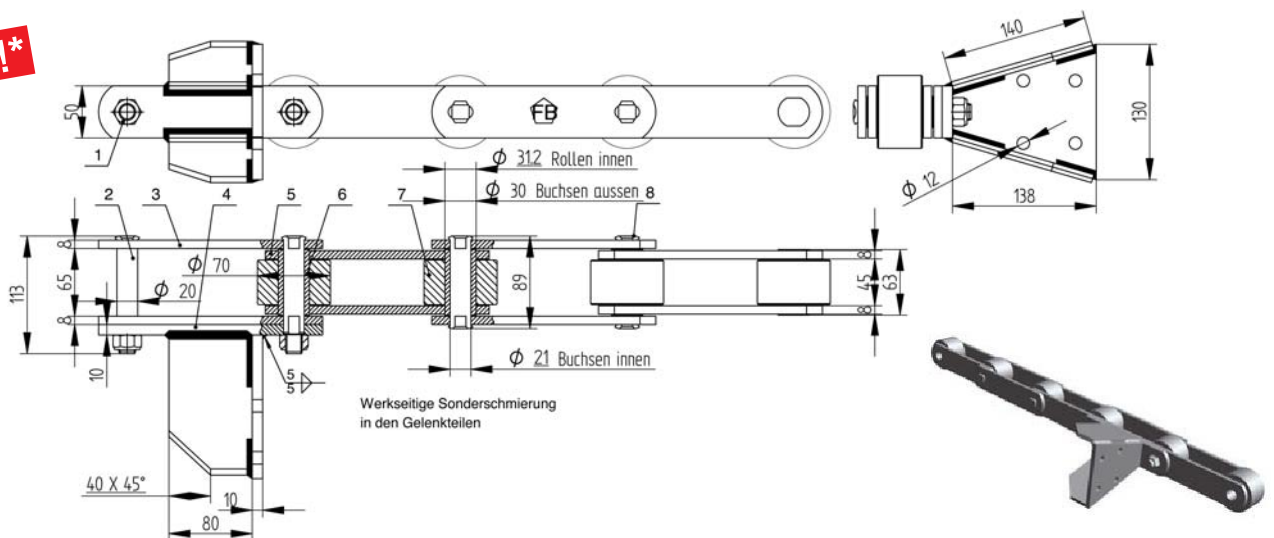

(FV90)A100T/F11x400, (FV90)A100T/F11x600

(attachment pitch 400 mm, 600 mm) for single or multiple chain conveyors

in stock!*

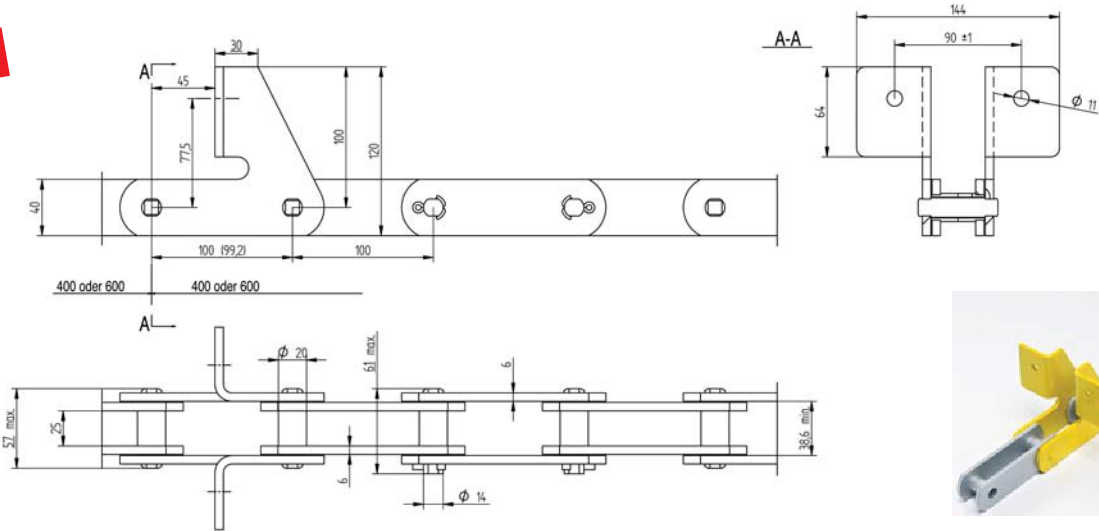

M112A100T/F11x600

(attachment pitch 600 mm) for single or multiple chain conveyors

in stock!*

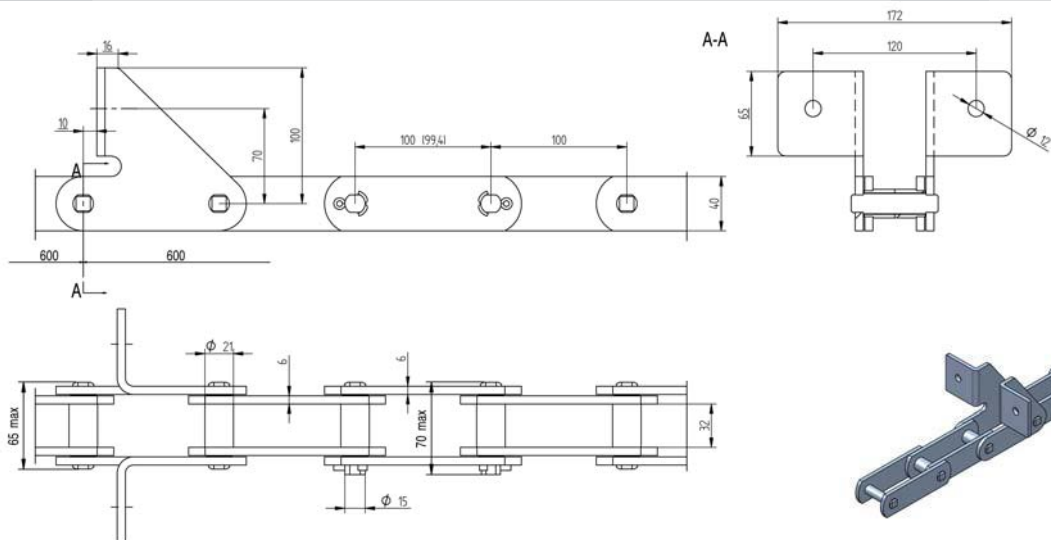

M112A100T/F2x400, M112A100T/F2x600

(attachment pitch 400 mm, 600 mm) for double chain conveyors

in stock!*

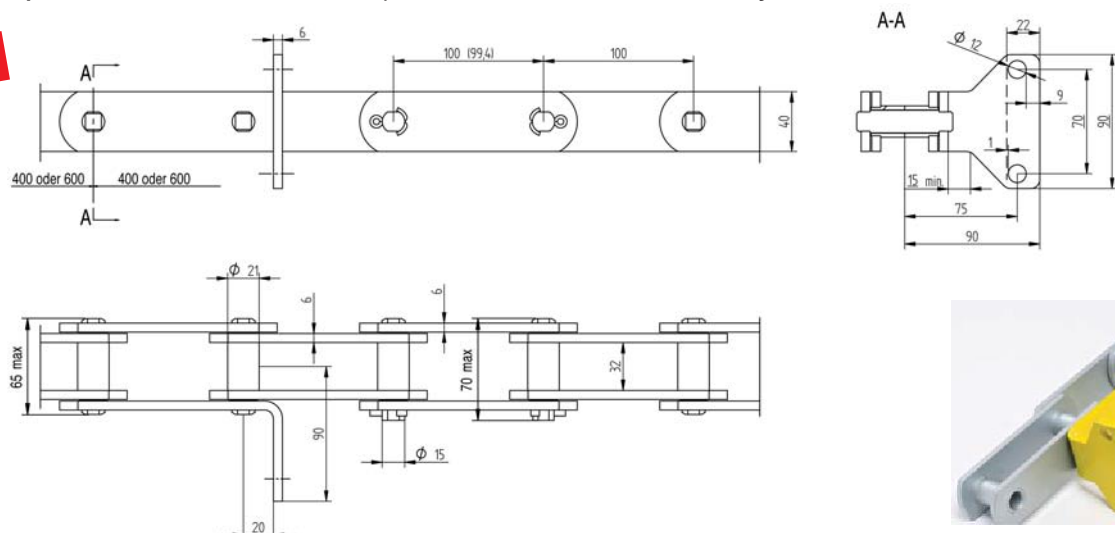

M112B100/(F2)x1000

(attachment pitch 1.000 mm or tailor made) for double chain conveyors

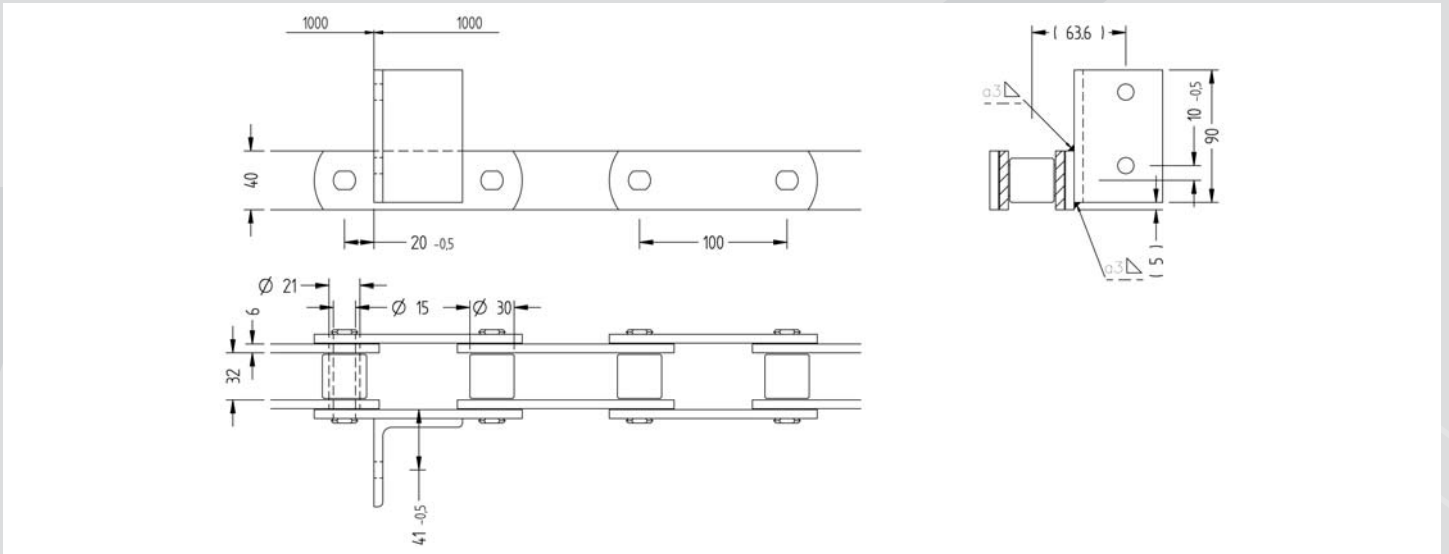

M112B100/(L2)x400

(attachment pitch 400 mm or tailor made) for double chain conveyors

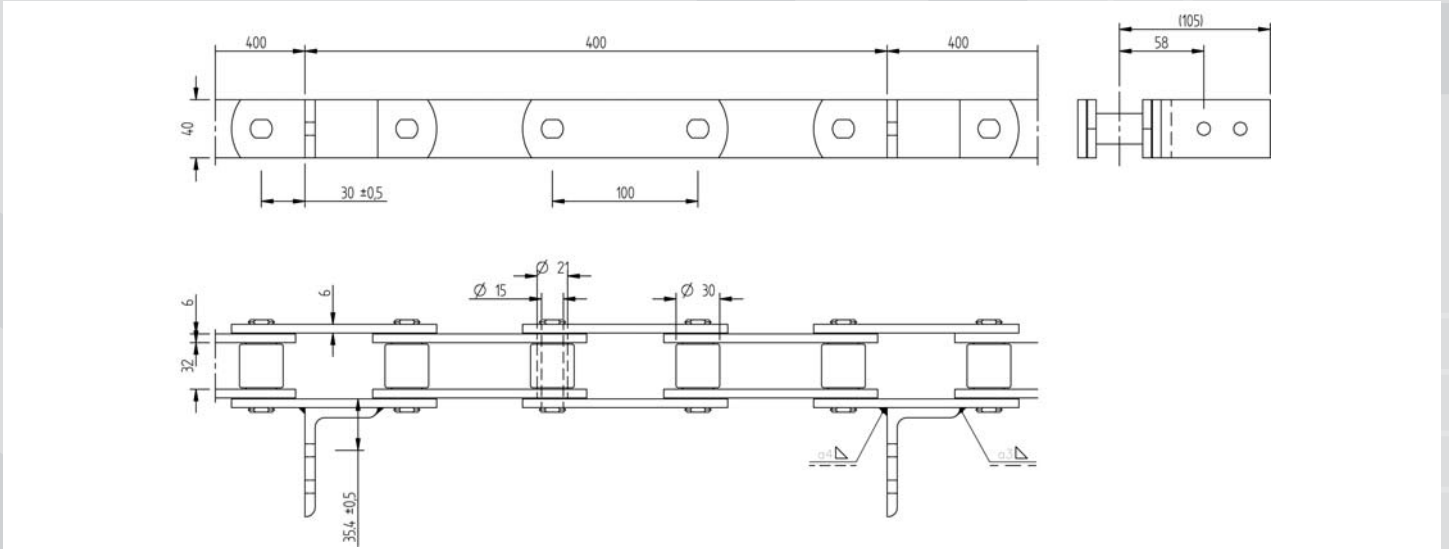

M112B100/(F4)x1200

(attachment pitch 1.200 mm or tailor made) for double chain conveyors

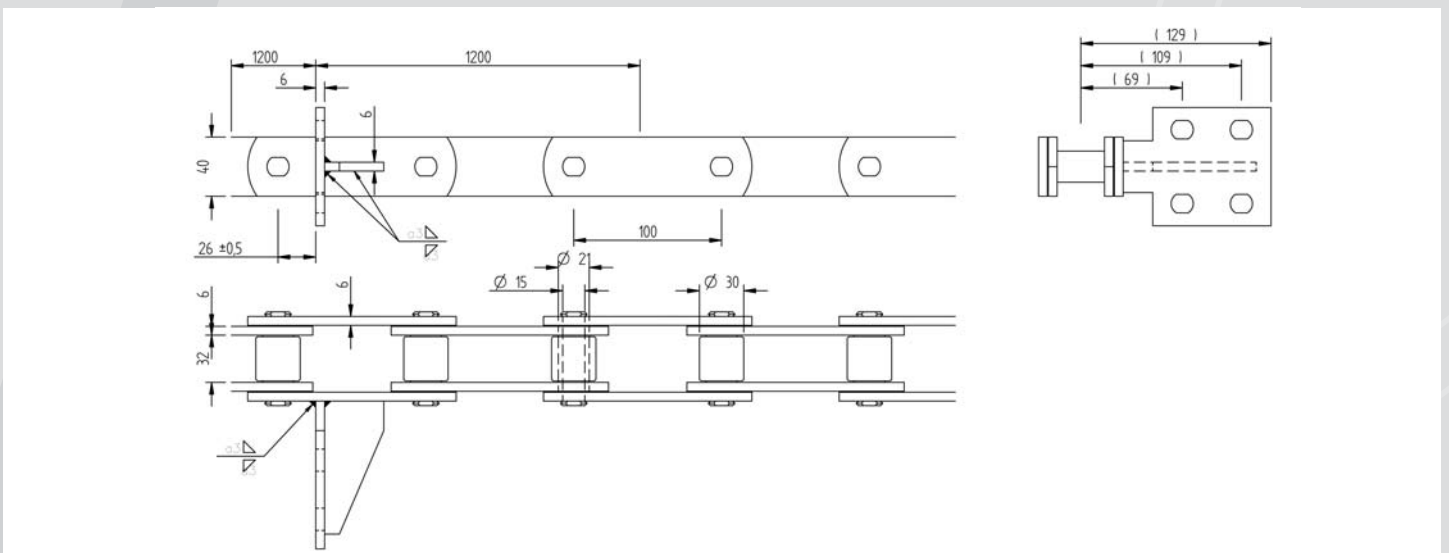

FV140A125T/F22x250, FV140A125T/F22x500, FV140A125T/F22x1000
 (attachment pitch 250, 500, 750 or 1.000 mm) for simplex and multiple chain conveyors

in stock!*

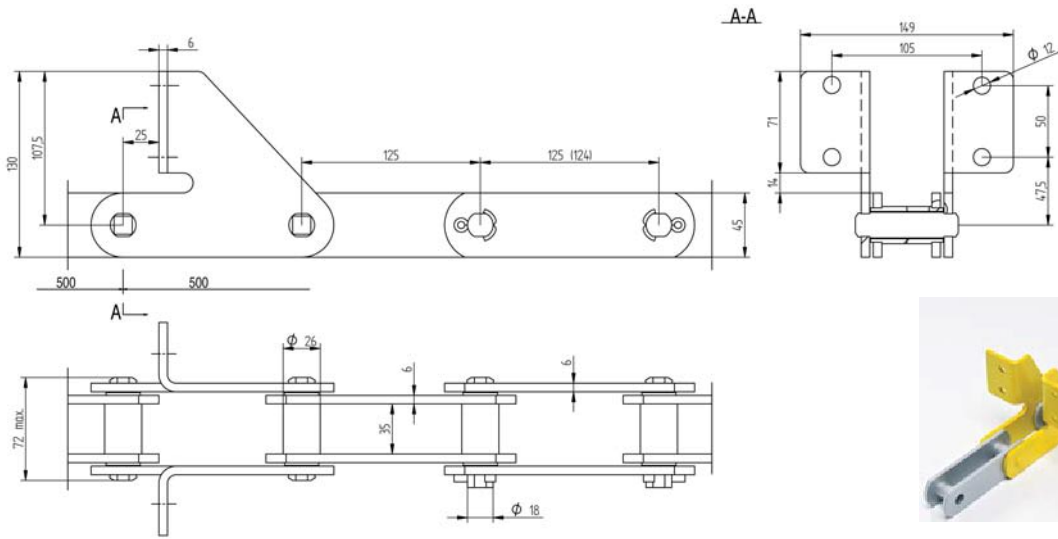

FV140A125T/T4x500, FV140A125T/T4x1000
 (attachment pitch 500 mm, 1.000 mm) for double chain conveyors

in stock!*

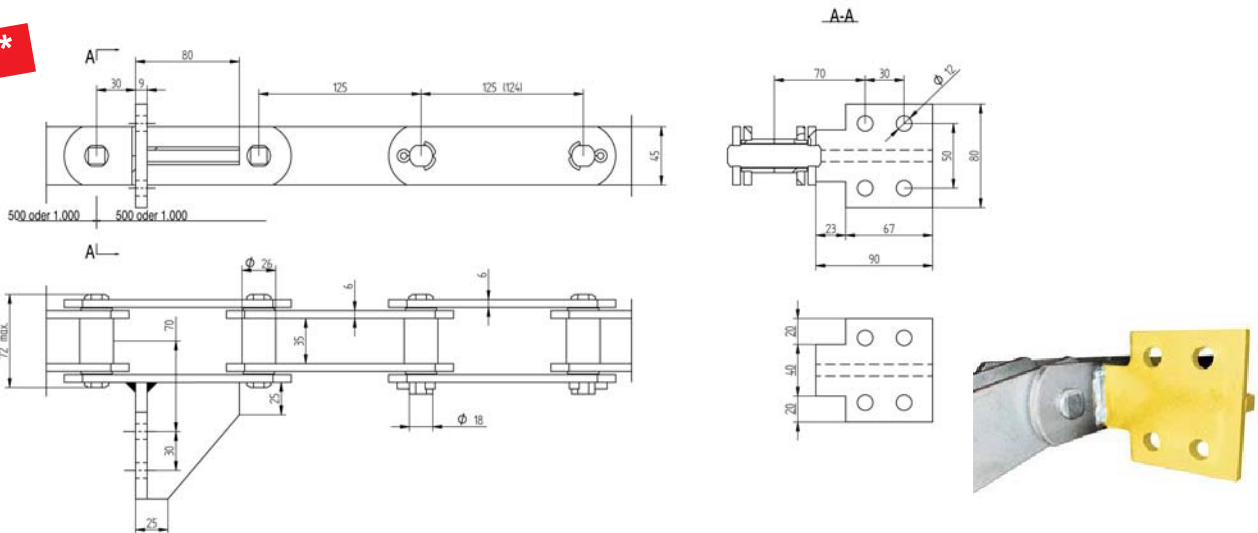

(M160)A160TERW/(F2)X640
 (attachment pitch 640 mm or tailor made, also with small rollers type B) for double chain conveyors

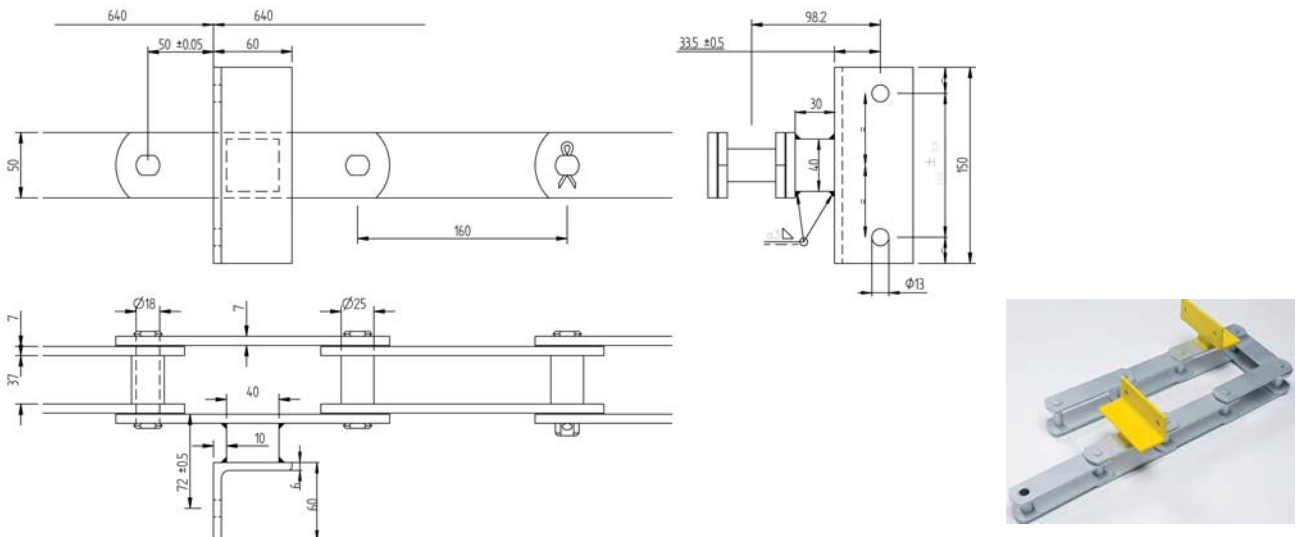



- Strong
- Stable
- Wear resistant – low friction μ_1 0,18 (with steel, not lubricated)
- 60% lighter than steel scrapers
- Avoid crashes and unplanned down time
- Increased operational safety
- Protect your chains
- Intended breaking point in case of overload material
- Bespoke solution – ready to install
- No bending!
- 4 quality levels
 - 100
 - 500
 - 1000
 - 1000 Xtra strong
- Easy disposal – harmless to the environment
- saves time & money!

No permanent deformation with INNO-scrapers!



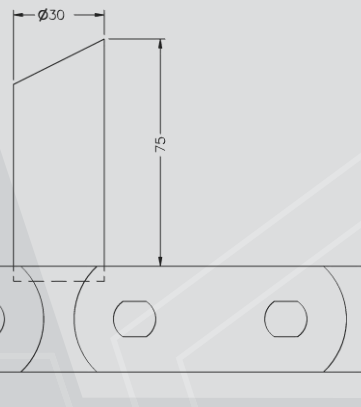
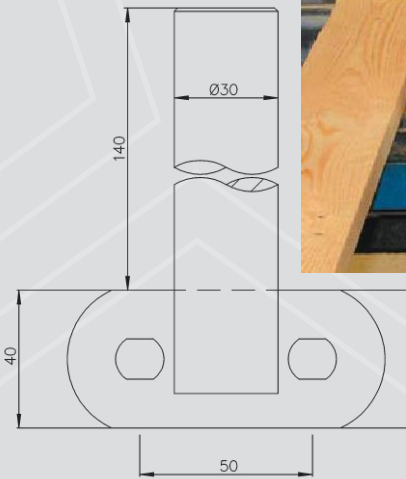
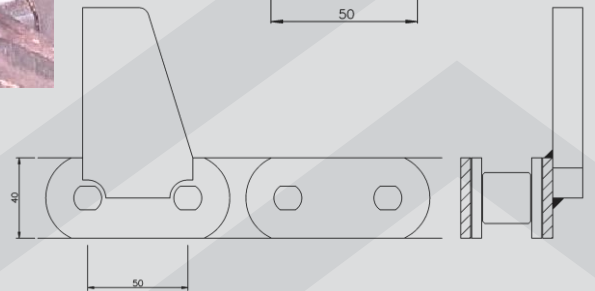
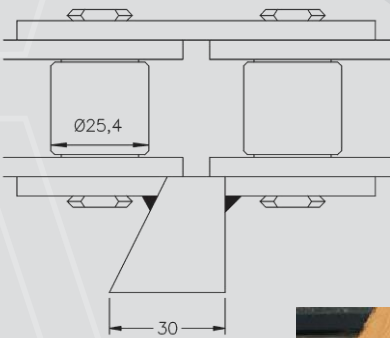
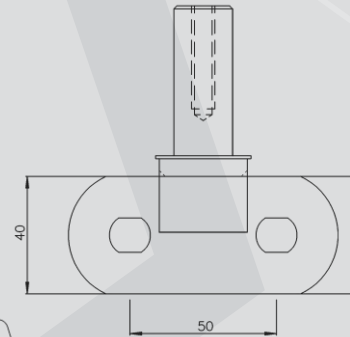
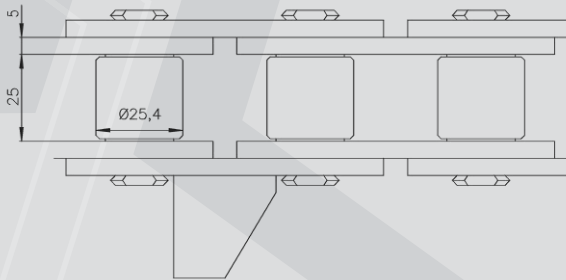
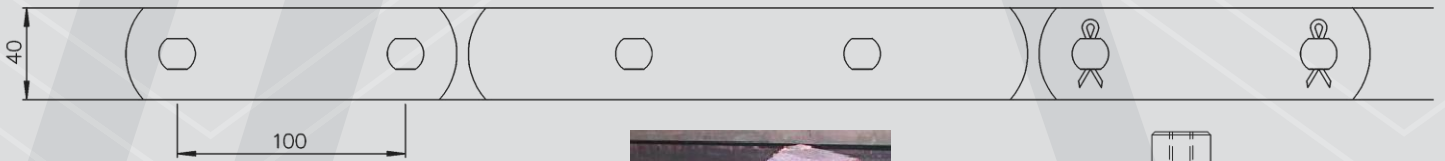
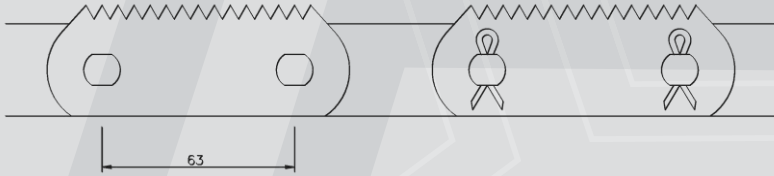
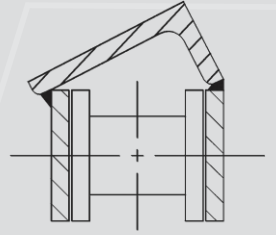
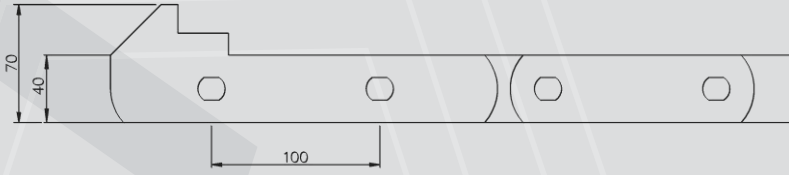

Examples for timber transport chains

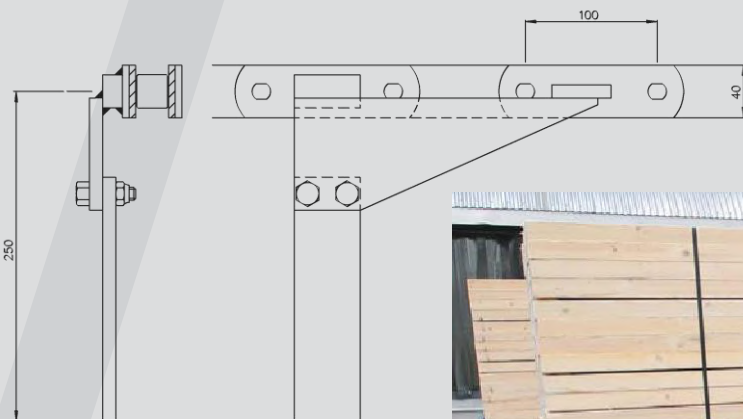
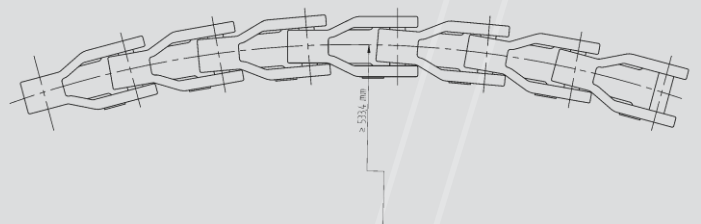
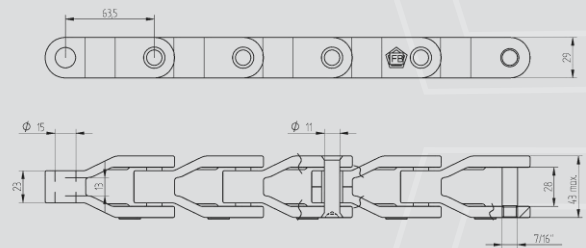
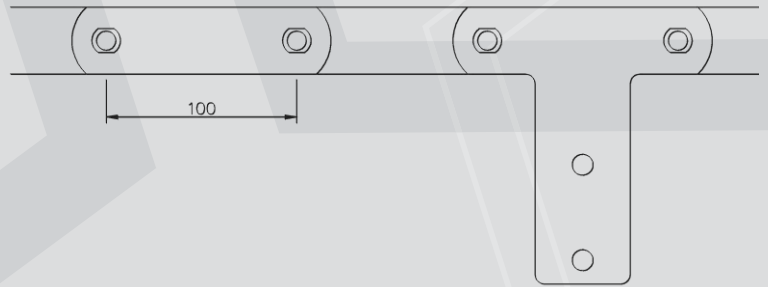
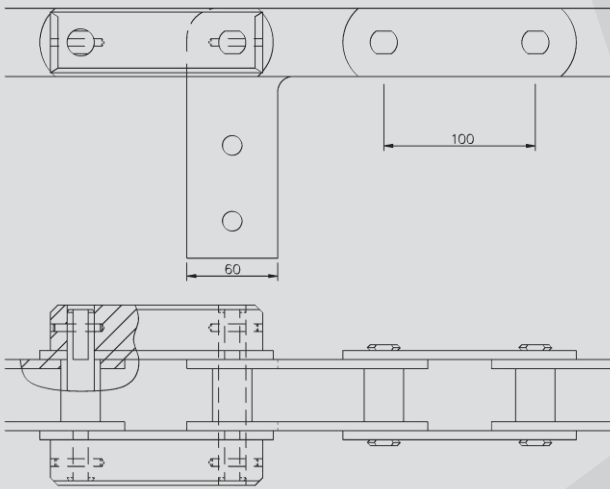

FB roller chains B series – DIN8187, ISO606

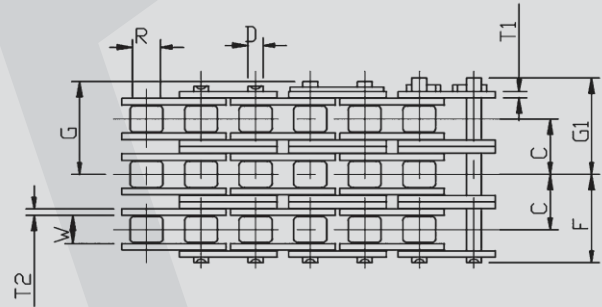
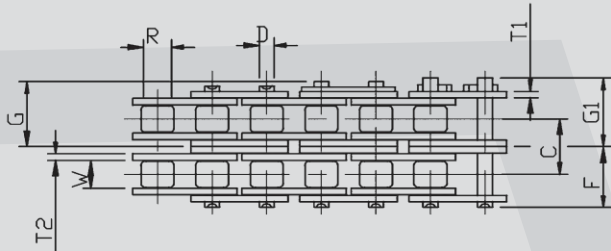
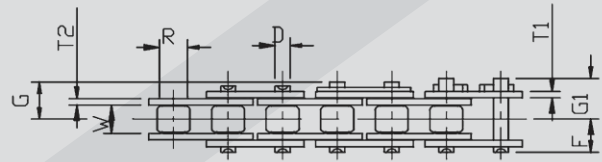
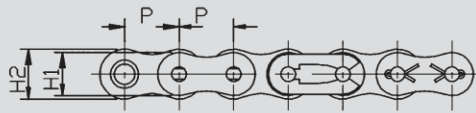

IN STOCK!*

DIN	PxW	P (mm)	W (mm)	R (mm)	sideplates				pin				C (mm)	breaking load		kg/m
					H1 (mm)	H2 (mm)	T1 (mm)	T2 (mm)	D (mm)	F (mm)	G (mm)	G1 (mm)		DIN (N)	FB (N)Ø	
06B-1	3/8x7/32"	9,525	5,72	6,35	8,10	8,10	1,00	1,25	3,28	6,10	7,40	-	-	9.000	10.301	0,39
06B-2	3/8x7/32"	9,525	5,72	6,35	8,10	8,10	1,00	1,25	3,28	11,20	12,30	-	10,24	16.900	18.639	0,74
06B-3	3/8x7/32"	9,525	5,72	6,35	8,10	8,10	1,00	1,25	3,28	16,30	17,40	17,80	10,24	24.900	26.487	1,09
08B-1	1/2x5/16"	12,7	7,75	8,51	10,20	11,80	1,50	1,50	4,44	8,20	9,50	-	-	18.000	18.933	0,65
08B-2	1/2x5/16"	12,7	7,75	8,51	10,20	11,80	1,50	1,50	4,44	15,30	16,70	-	13,92	32.000	35.316	1,30
08B-3	1/2x5/16"	12,7	7,75	8,51	10,20	11,80	1,50	1,50	4,44	22,20	23,50	23,80	13,92	47.500	52.974	1,92
10B-1	5/8x3/8"	15,875	9,65	10,16	13,00	14,60	1,65	1,65	5,06	9,60	11,10	-	-	22.400	26.487	0,92
10B-2	5/8x3/8"	15,875	9,65	10,16	13,00	14,60	1,65	1,65	5,06	17,90	19,4	-	16,59	44.500	51.012	1,68
10B-3	5/8x3/8"	15,875	9,65	10,16	13,00	14,60	1,65	1,65	5,06	26,20	27,5	28,20	16,59	66.700	77.009	2,62
12B-1	3/4x7/16"	19,05	11,68	12,07	16,00	16,00	1,80	1,80	5,72	11,10	12,6	-	-	29.000	33.354	1,24
12B-2	3/4x7/16"	19,05	11,68	12,07	16,00	16,00	1,80	1,80	5,72	20,80	22,4	-	19,46	57.800	66.708	2,28
12B-3	3/4x7/16"	19,05	11,68	12,07	16,00	16,00	1,80	1,80	5,72	30,60	31,9	32,50	19,46	86.700	100.062	3,55
16B-1	1"x17,02 mm	25,40	17,02	15,88	20,80	20,80	3,20	4,00	8,27	17,70	19,25	20,20	-	60.000	78.480	2,65
16B-2	1"x17,02 mm	25,40	17,02	15,88	20,80	20,80	3,20	4,00	8,27	33,64	35,16	36,16	31,88	106.000	156.960	5,25
16B-3	1"x17,02 mm	25,40	17,02	15,88	20,80	20,80	3,20	4,00	8,27	49,58	51,12	52,12	31,88	160.000	235.440	7,86
20B-1	1 1/4x3/4"	31,75	19,56	19,05	26,00	26,00	3,50	4,40	10,18	20,50	-	23,50	-	95.000	117.720	3,85
20B-2	1 1/4x3/4"	31,75	19,56	19,05	26,00	26,00	3,50	4,40	10,18	38,73	-	41,72	36,45	170.000	235.440	7,65
20B-3	1 1/4x3/4"	31,75	19,56	19,05	26,00	26,00	3,50	4,40	10,18	56,95	-	59,95	36,45	250.000	353.160	11,45
24B-1	1 1/2x1"	38,10	25,40	25,40	33,00	33,00	5,20	6,00	14,62	26,65	-	32,35	-	160.000	176.580	7,60
24B-2	1 1/2x1"	38,10	25,40	25,40	33,00	33,00	5,20	6,00	14,62	50,83	-	56,53	48,36	280.000	343.350	14,80
24B-3	1 1/2x1"	38,10	25,40	25,40	33,00	33,00	5,20	6,00	14,62	75,00	-	80,72	48,36	425.000	515.025	21,90
28B-1	1 3/4x 1 1/4"	44,45	31,00	27,94	37,00	37,00	6,40	7,40	15,90	32,48	-	37,97	-	200.000	206.010	9,05
28B-2	1 3/4x 1 1/4"	44,45	31,00	27,94	37,00	37,00	6,40	7,40	15,90	62,26	-	67,75	59,56	360.000	402.210	17,12
28B-3	1 3/4x 1 1/4"	44,45	31,00	27,94	37,00	37,00	6,40	7,40	15,90	92,04	-	97,53	59,56	530.000	588.600	25,61
32B-1	2x 1 1/4"	50,80	31,00	29,21	42,00	42,00	6,40	7,10	17,81	32,68	-	38,17	-	250.000	259.965	10,63
32B-2	2x 1 1/4"	50,80	31,00	29,21	42,00	42,00	6,40	7,10	17,81	61,95	-	67,45	58,55	450.000	495.405	20,85
32B-3	2x 1 1/4"	50,80	31,00	29,21	42,00	42,00	6,40	7,10	17,81	91,23	-	96,72	58,55	670.000	745.560	31,57
40B-1	2 1/2x1 1/2"	63,50	38,10	39,37	52,90	52,90	8,00	8,00	22,89	40,20	-	47,30	-	355.000	388.476	16,25
40B-2	2 1/2x1 1/2"	63,50	38,10	39,37	52,90	52,90	8,00	8,00	22,89	76,35	-	83,45	72,29	630.000	745.560	31,86
40B-3	2 1/2x1 1/2"	63,50	38,10	39,37	52,90	52,90	8,00	8,00	22,89	112,50	-	119,60	72,29	950.000	1.098.720	48,14
48B-1	3x1 3/4"	76,20	45,72	48,26	63,50	63,50	9,90	11,80	29,24	49,40	-	56,50	-	560.000	610.182	25,05
48B-2	3x1 3/4"	76,20	45,72	48,26	63,50	63,50	9,90	11,80	29,24	95,00	-	102,10	91,21	1.000.000	1.157.580	49,83
48B-3	3x1 3/4"	76,20	45,72	48,26	63,50	63,50	9,90	11,80	29,24	140,60	-	147,70	91,21	1.500.000	1.736.370	75,07
56B-1	3 1/2"x53,34 mm	88,90	53,34	53,98	77,85	77,85	13,00	15,00	34,32	117,00	-	137,00	-	850.000	850.000	35,78
56B-2	3 1/2"x53,34 mm	88,90	53,34	53,98	77,85	77,85	13,00	15,00	34,32	223,00	-	243,60	106,60	1.600.000	1.600.000	70,00
56B-3	3 1/2"x53,34 mm	88,90	53,34	53,98	77,85	77,85	13,00	15,00	34,32	330,50	-	350,20	106,60	2.240.000	2.240.000	105,00

Some dimensions may vary because of tolerances in the prime material.



CG



SG



SG...wire



NG



KG



DKG



IG

FB roller chains A series – DIN8188, ASA

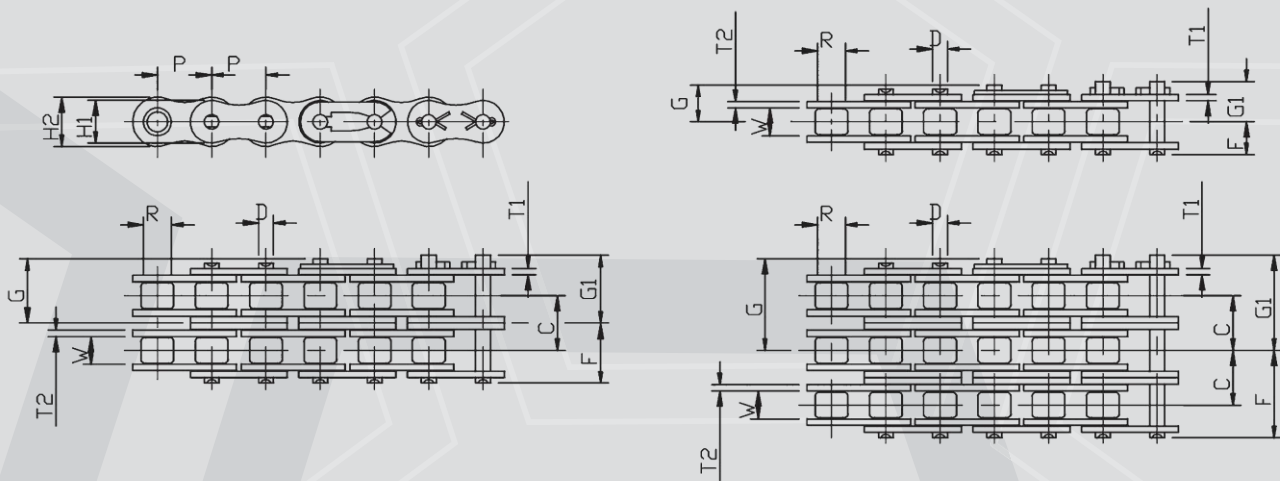

IN STOCK!*

ANSI	PxW	P (mm)	W (mm)	R (mm)	sideplates				pin				C (mm)	breaking load		kg/m
					H1 (mm)	H2 (mm)	T1 (mm)	T2 (mm)	D (mm)	F (mm)	G (mm)	G1 (mm)		DIN (N)	FB (N) Ø	
40-1	1/2x5/16"	12,7	7,95	7,92	10,20	11,80	1,50	1,50	3,96	8,20	9,35	10,00	-	14.100	18.149	0,63
40-2	1/2x5/16"	12,7	7,95	7,92	10,20	11,80	1,50	1,50	3,96	15,30	17,00	17,60	14,40	28.200	36.297	1,19
40-3	1/2x5/16"	12,7	7,95	7,92	10,20	11,80	1,50	1,50	3,96	22,65	23,80	24,55	14,40	42.300	54.446	1,77
50-1	5/8x3/8"	15,875	9,53	10,16	13,00	14,80	2,00	2,00	5,06	10,10	11,65	12,60	-	22.200	30.411	1,01
50-2	5/8x3/8"	15,875	9,53	10,16	13,00	14,80	2,00	2,00	5,06	19,20	20,70	21,10	18,10	44.400	60.822	2,04
50-3	5/8x3/8"	15,875	9,53	10,16	13,00	14,80	2,00	2,00	5,06	28,30	29,65	30,20	18,10	66.600	91.233	3,05
60-1	3/4x1/2"	19,05	12,70	11,91	15,50	17,50	2,40	2,40	5,95	12,50	14,15	15,40	-	31.800	43.164	1,44
60-2	3/4x1/2"	19,05	12,70	11,91	15,50	17,50	2,40	2,40	5,95	24,00	25,50	26,90	22,80	63.600	86.328	3,03
60-3	3/4x1/2"	19,05	12,70	11,91	15,50	17,50	2,40	2,40	5,95	35,35	36,95	37,65	22,80	95.400	129.492	4,50
80-1	1x5/8"	25,40	15,88	15,88	20,40	23,90	3,10	3,10	7,94	16,10	17,75	18,80	-	56.700	76.518	2,40
80-2	1x5/8"	25,40	15,88	15,88	20,40	23,90	3,10	3,10	7,94	30,60	32,20	33,60	29,30	113.400	153.036	5,26
80-3	1x5/8"	25,40	15,88	15,88	20,40	23,90	3,10	3,10	7,94	45,30	47,00	48,00	29,30	170.100	229.554	7,80
100-1	1 1/4x3/4"	31,75	19,05	19,05	24,80	30,10	3,90	3,90	9,52	20,10	-	23,10	-	88.500	115.758	3,74
100-2	1 1/4x3/4"	31,75	19,05	19,05	24,80	30,10	3,90	3,90	9,52	38,00	-	41,00	35,80	177.000	231.516	7,51
100-3	1 1/4x3/4"	31,75	19,05	19,05	24,80	30,10	3,90	3,90	9,52	55,90	-	58,90	35,80	265.500	347.274	11,20
120-1	1 1/2x1"	38,10	25,40	22,23	30,00	35,00	4,70	4,70	11,10	25,20	-	28,60	-	127.000	152.055	6,18
120-2	1 1/2x1"	38,10	25,40	22,23	30,00	35,00	4,70	4,70	11,10	47,90	-	51,30	45,40	254.000	304.110	12,25
120-3	1 1/2x1"	38,10	25,40	22,23	30,00	35,00	4,70	4,70	11,10	70,60	-	74,00	45,40	381.000	456.165	18,30
140-1	1 3/4x1"	44,45	25,40	25,40	36,20	42,00	5,60	5,60	12,70	27,30	-	31,50	-	172.400	210.915	7,49
140-2	1 3/4x1"	44,45	25,40	25,40	36,20	42,00	5,60	5,60	12,70	51,75	-	55,75	48,90	344.800	421.830	14,83
140-3	1 3/4x1"	44,45	25,40	25,40	36,20	42,00	5,60	5,60	12,70	76,20	-	80,40	48,90	571.200	632.745	22,20
160-1	2x 1 1/4"	50,80	31,75	28,58	41,40	48,00	6,40	6,40	14,28	32,55	-	37,25	-	226.800	269.775	10,10
160-2	2x 1 1/4"	50,80	31,75	28,58	41,40	48,00	6,40	6,40	14,28	61,80	-	66,50	58,50	453.600	539.550	20,04
160-3	2x 1 1/4"	50,80	31,75	28,58	41,40	48,00	6,40	6,40	14,28	91,05	-	95,75	58,50	680.400	809.325	30,02
200-1	2 1/2x1 1/2"	63,50	38,10	39,68	51,80	60,10	8,00	8,00	19,84	39,75	-	47,10	-	353.800	451.260	16,50
200-2	2 1/2x1 1/2"	63,50	38,10	39,68	51,80	60,10	8,00	8,00	19,84	75,55	-	82,85	71,60	707.600	902.520	32,70
200-3	2 1/2x1 1/2"	63,50	38,10	39,68	51,80	60,10	8,00	8,00	19,84	111,35	-	118,65	71,60	1.061.400	1.353.780	49,05
240-1	3x1 7/8"	76,20	47,63	47,60	62,40	72,20	9,50	9,50	23,80	47,70	-	54,80	-	510.300	671.985	24,20
240-2	3x1 7/8"	76,20	47,63	47,60	62,40	72,20	9,50	9,50	23,80	91,60	-	98,70	87,80	1.020.600	1.343.970	47,80
240-3	3x1 7/8"	76,20	47,63	47,60	62,40	72,20	9,50	9,50	23,80	135,50	-	142,60	87,80	1.530.900	2.015.955	71,10

Some dimensions may vary slightly because of tolerances in the prime material:

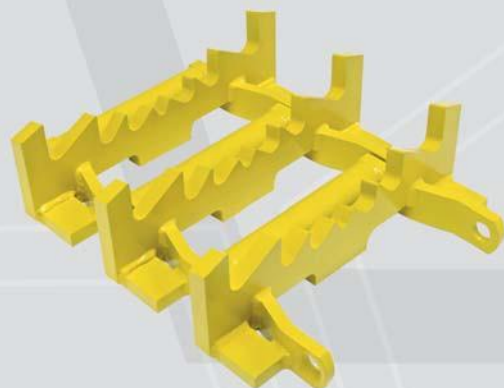

FB roller chains straight sideplates

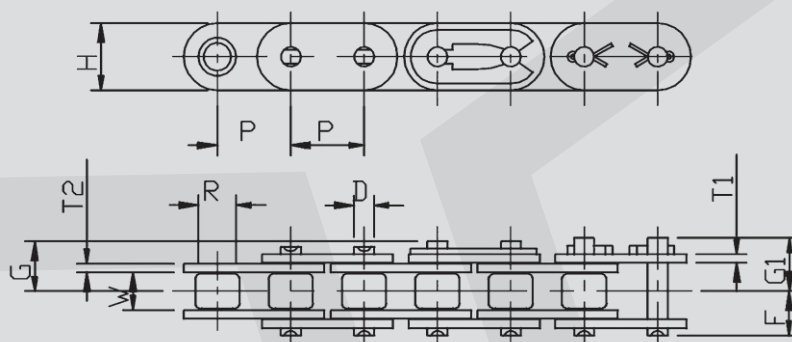

Type	PxW	P (mm)	W (mm)	R (mm)	sideplates		pin				Breaking load			
					H (mm)	T1 (mm)	T2 (mm)	D (mm)	F (mm)	G (mm)	G1 (mm)	DIN (N)	FB (N) Ø	kg/m
06B-1FB	3/8x7/32"	9,525	5,72	6,35	8,10	1,00	1,25	3,28	6,10	7,40	-	9.000	10.301	0,39
08B-1DGL11,8	1/2x5/16"	12,7	7,75	8,51	11,80	1,50	1,50	4,44	8,20	9,50	-	18.000	18.933	0,75
10B-1DGL14,7	5/8x3/8"	15,875	9,65	10,16	14,70	1,65	1,65	5,06	9,60	11,10	-	22.400	26.487	1,00
12B-1TGL16,1	3/4x7/16"	19,05	11,68	12,07	16,10	1,80	1,80	5,72	11,10	12,6	-	29.000	33.354	1,29
16B-1FBGL21	1"x17,02 mm	25,40	17,02	15,88	21,00	3,20	4,00	8,27	17,70	19,25	20,20	60.000	78.480	2,70
16B-1FBGL24	1"x17,02 mm	25,40	17,02	15,88	24,00	3,20	4,00	8,27	17,70	19,25	20,20	60.000	78.480	3,30
20B-1TGL26,4	1 1/4x3/4"	31,75	19,56	19,05	26,40	3,50	4,40	10,18	20,50	-	23,50	95.000	117.720	4,25
24B-1TGL33	1 1/2x1"	38,10	25,40	25,40	33,00	5,20	6,00	14,62	26,65	-	32,35	160.000	176.580	8,20
32B-1TGL42,2	2x1 1/4"	50,80	30,99	29,21	42,20	7,00	6,30	17,81	33,40	-	37,60	250.000	250.000	10,90

FB double pitch rollerchains

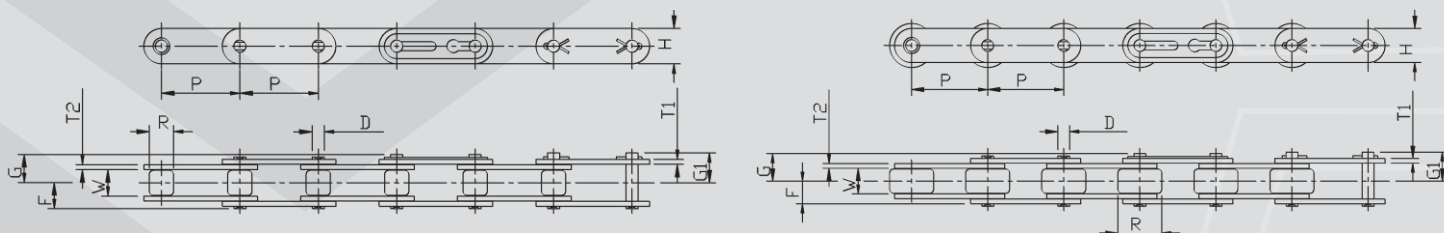

Type	PxW	P (mm)	W (mm)	R (mm)	sideplates		pin				breaking load		
					H (mm)	T1 (mm)	T2 (mm)	D (mm)	F (mm)	G (mm)	G1 (mm)	N	kg/m
C2040	1"x5/16"	25,40	7,92	7,92	11,70	1,50	1,50	3,96	8,20	9,35	10,10	18.149	0,49
C2042	1"x5/16"	25,40	7,94	15,88	11,70	1,50	1,50	3,96	8,20	9,35	10,10	18.149	0,86
C2050	1 1/4"x3/8"	31,75	9,53	10,16	14,60	2,00	2,00	5,06	10,10	11,65	12,60	30.411	0,84
C2052	1 1/4"x3/8"	31,75	9,53	19,05	14,60	2,00	2,00	5,06	10,10	11,65	12,60	30.411	1,32
C2060HFB	1 1/2"x1/2"	38,10	12,70	11,91	17,10	3,10	3,10	5,95	14,10	15,70	16,60	43.164	1,45
C2062H	1 1/2"x1/2"	38,10	12,70	22,23	17,10	3,10	3,10	5,95	14,10	15,70	16,60	43.164	2,17
C2080HFB	2"x5/8"	50,80	15,88	15,88	23,00	3,90	3,90	7,94	17,90	19,40	20,80	78.480	2,41
C2082H	2"x5/8"	50,80	15,88	28,58	23,00	3,90	3,90	7,94	17,90	19,40	20,80	78.480	2,87
C2100H	2 1/2"x3/4"	63,50	19,05	19,05	28,90	4,70	4,70	9,52	21,70		24,90	117.720	3,50
C2102H	2 1/2"x3/4"	63,50	19,05	39,67	28,90	4,70	4,70	9,52	21,70		24,90	117.720	4,68
C2120H	3"x1"	76,20	25,40	22,20	35,00	5,60	5,60	11,10	26,98		30,57	156.960	6,00
C2122H	3"x1"	76,20	25,40	44,45	35,00	5,60	5,60	11,10	26,98		30,57	156.960	8,00
C2160H	4"x1 1/4"	101,60	31,75	28,58	48,00	7,20	7,20	14,28	34,15		38,85	269.775	8,90
C2162H	4"x1 1/4"	101,60	31,75	57,15	48,00	7,20	7,20	14,28	34,15		38,85	269.775	13,60

Other dimensions on request.

Straight attachments - Pushers

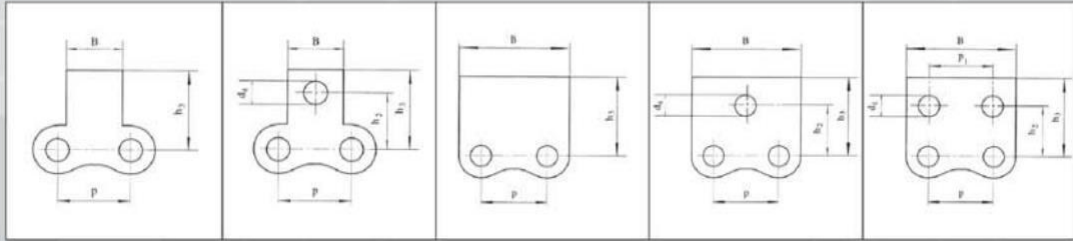

Angle attachments

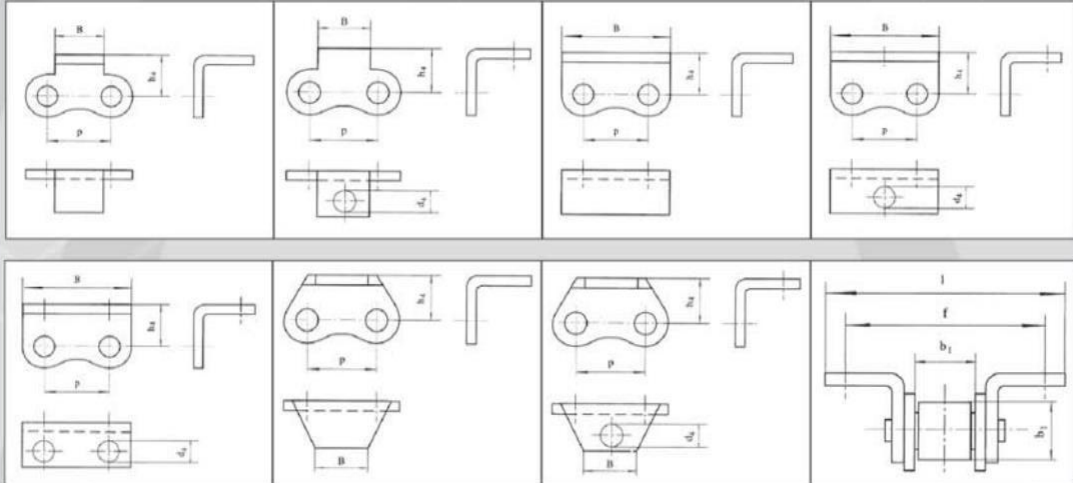

Extended pins

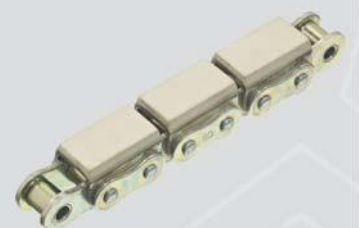
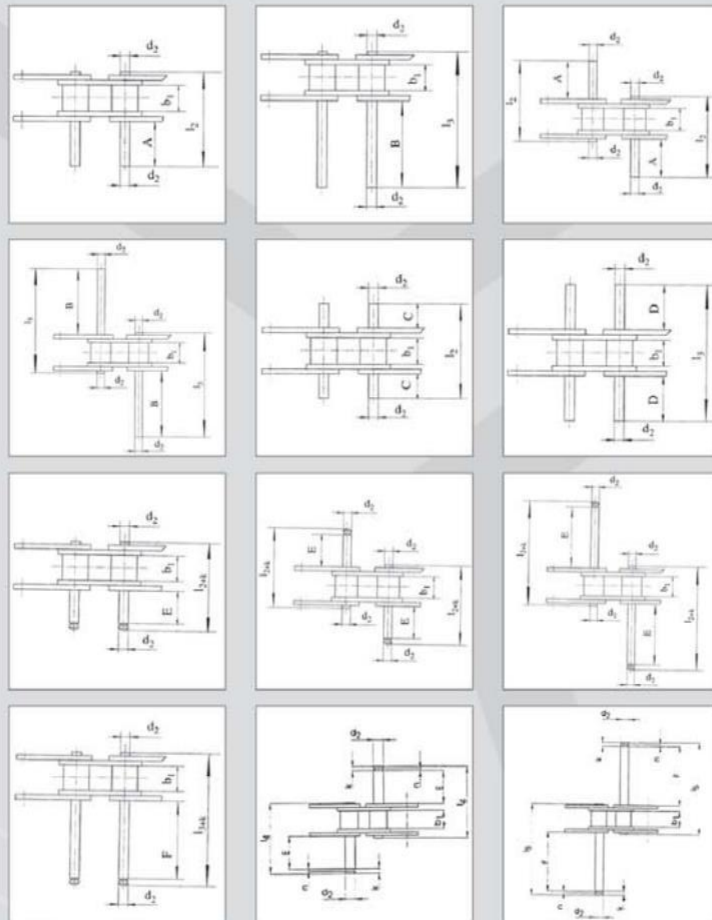

Other dimensions and design on request

IN STOCK!*

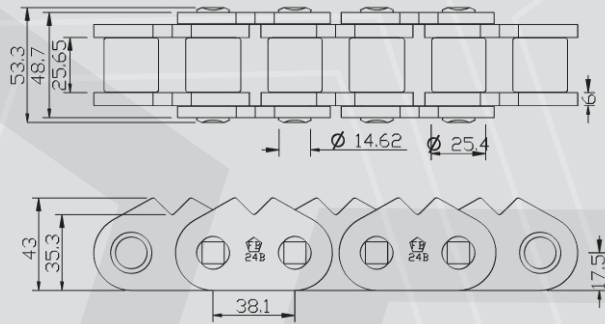

5152.000.23FB

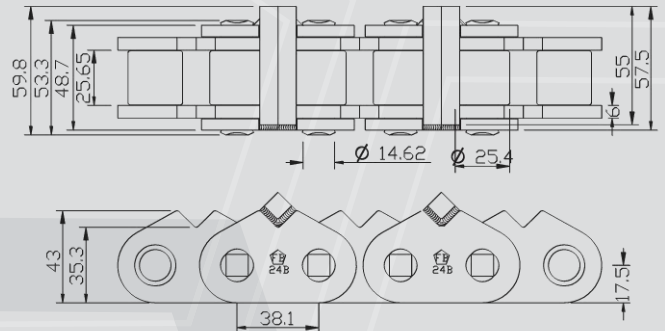

5152.000.29FB

Log turning – log positioning

IN STOCK!*

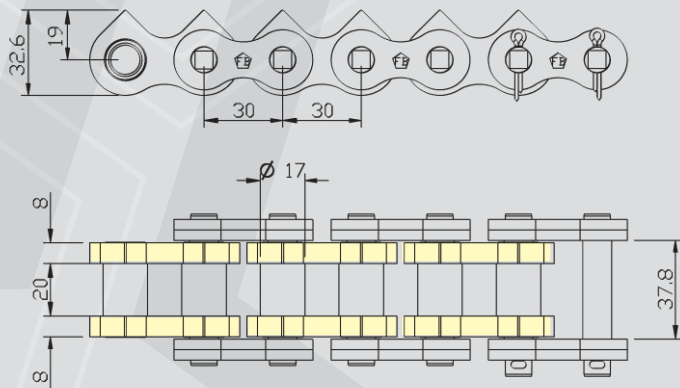

BK20.30FBVERZx60I
frame saw

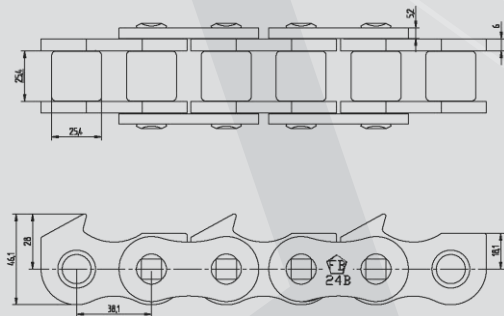

24B-1FBVERZ1X76,2I/OWB
band saw

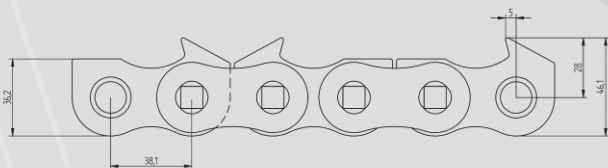
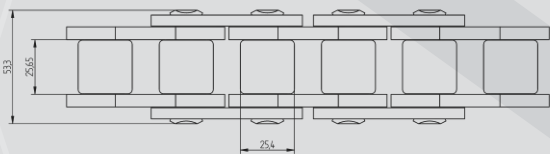

log positioning – log turning

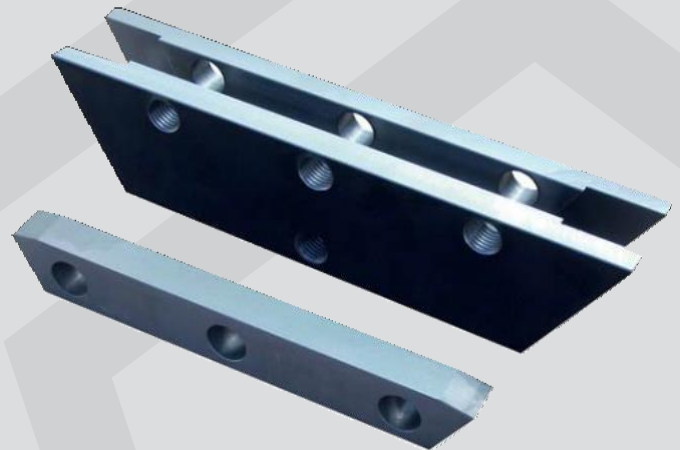

Canter lines + band saw

IN STOCK!*

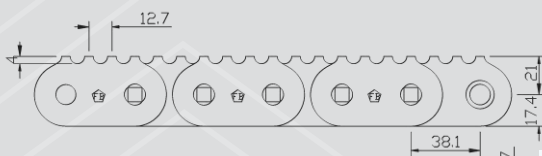

LEK120-1FB

band saw

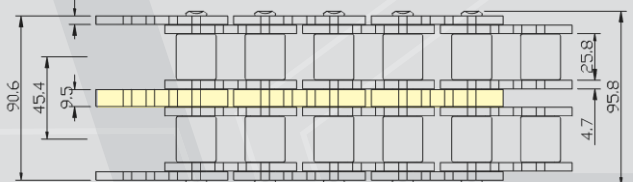
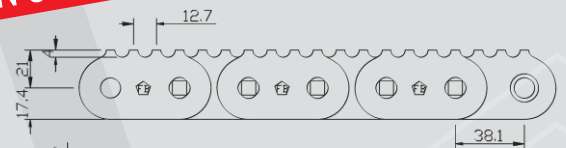

LEK120-2FB
canter infeed chain

FB Sharp Top Chains for canters and saws

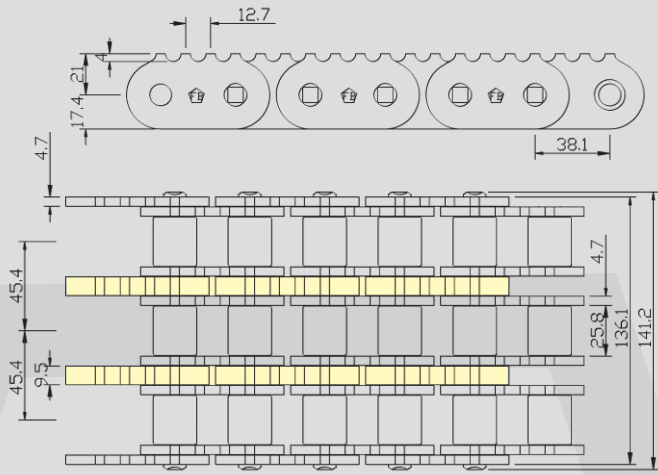

LEK120-3FB
canter infeed chain

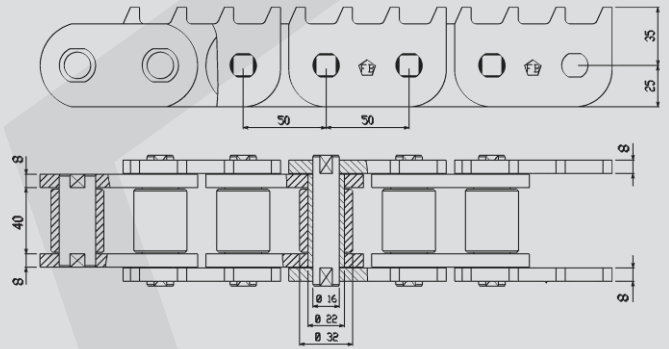

LZK40.50FB-50x8
outfeed chain

IN STOCK!*

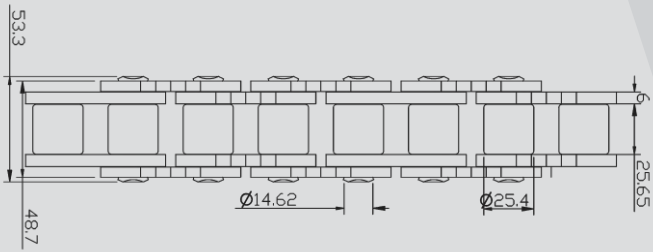

24B-1FBFVERZS/PLx152,4I
canter chains

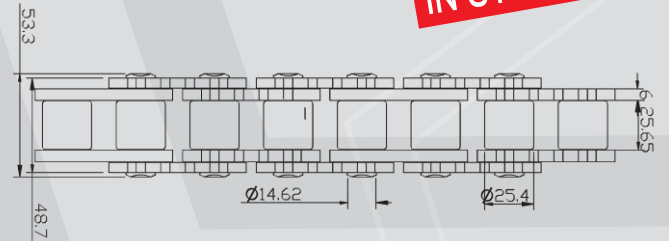

24B-1FBFVERZ/PLx152,4I
canter chains

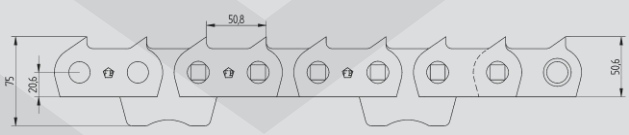

32B-1FBVERZS2/PL203I
canter chains

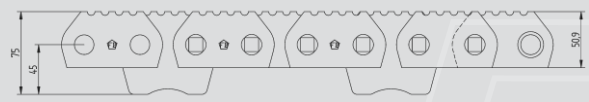

32B-1FBFVERZ5/PLx203,2I
canter chains

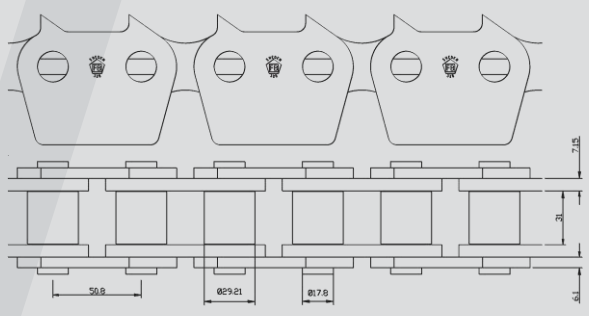

5269.000.4
canter chain

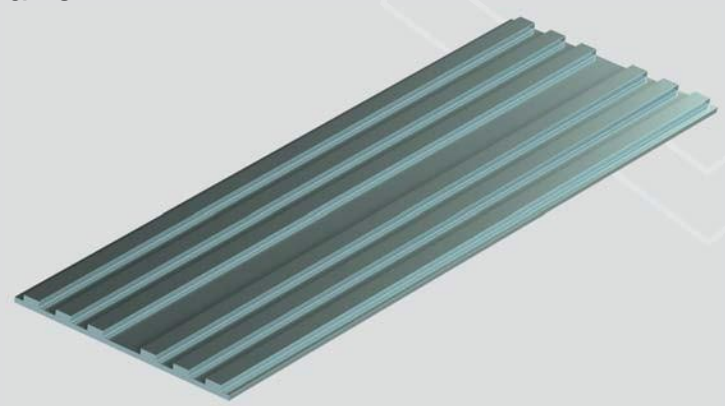

chain rails – canter infeed (chain-bed)

IN STOCK!*

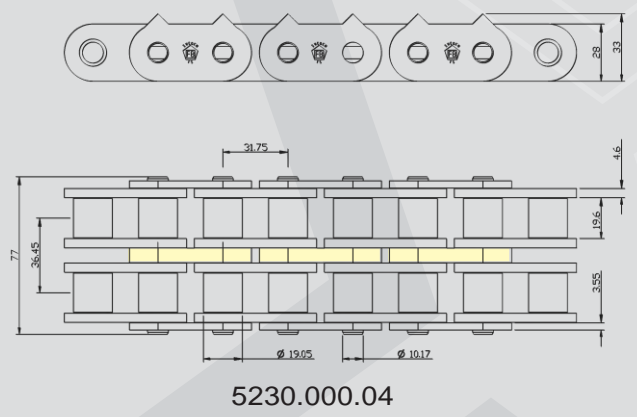
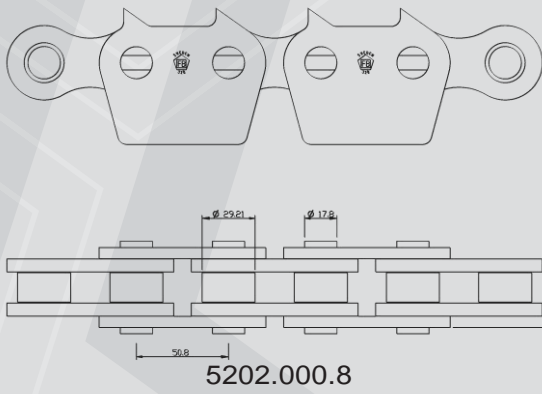
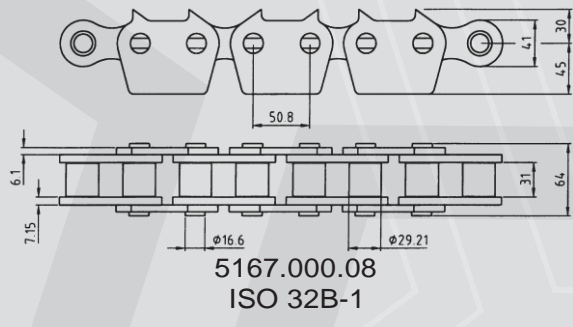

Special hardened pin

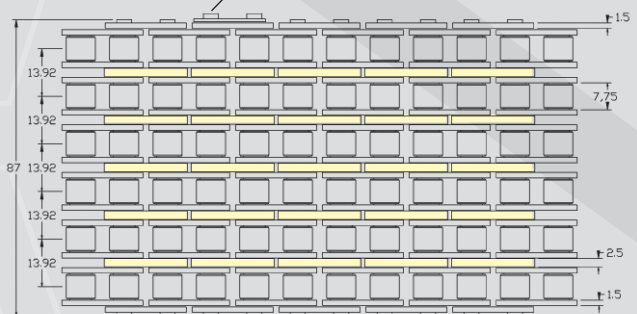

Hardened teeth



08B-3/08B-6FBVERZAHNTx25,4

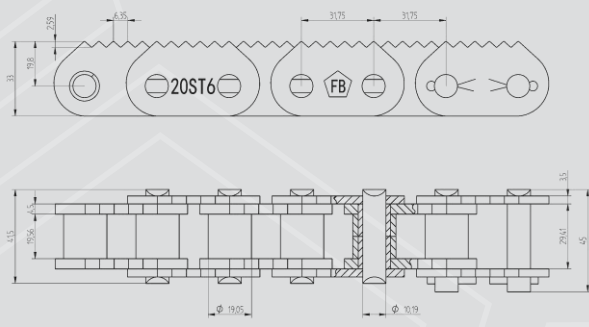
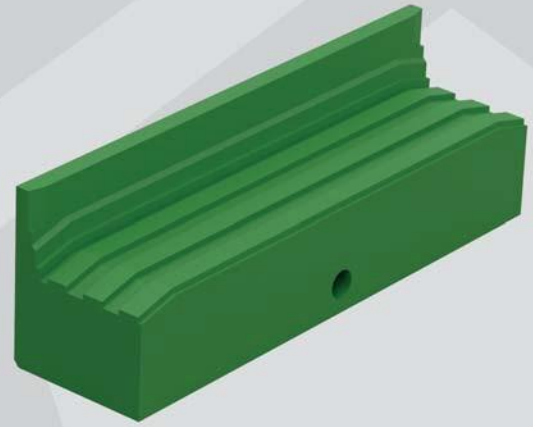

5130.000.22FB

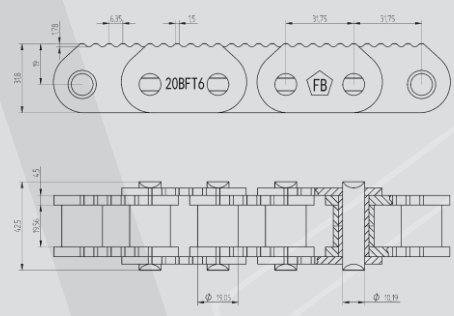

5130.000.23FB

Other dimensions and design on request

FB Sharp Top Chains for edgers

IN STOCK!*

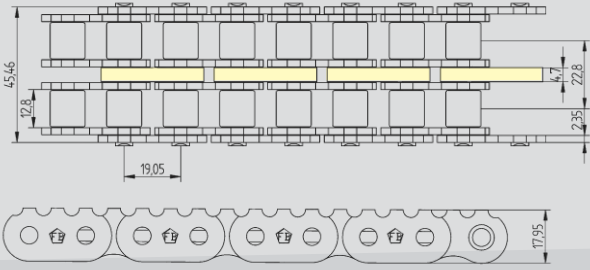

60-2VERZ94060904
60-3VERZ94060905

edger / circular saw

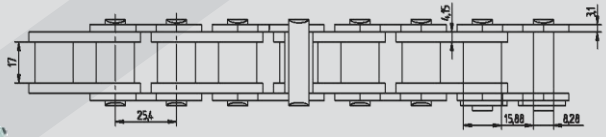

16B-1FBVERZAHNTx50,8
5118.000.34

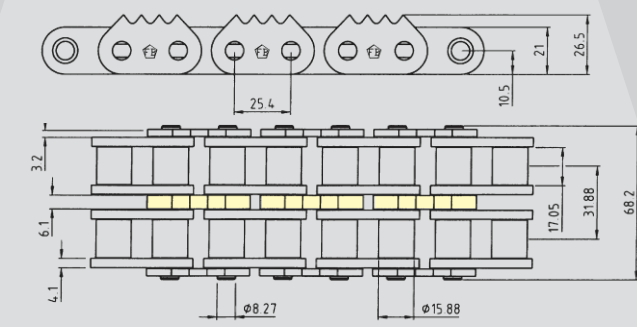

5218.000.18 5318.000.06
16B-2 16B-3

edger

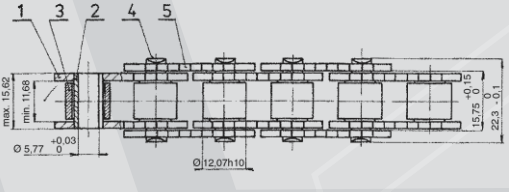
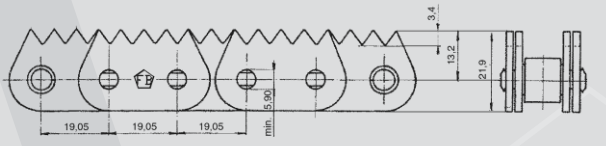

12B-1FBVERZAHNTS5
12B-2FBVERZAHNTS5

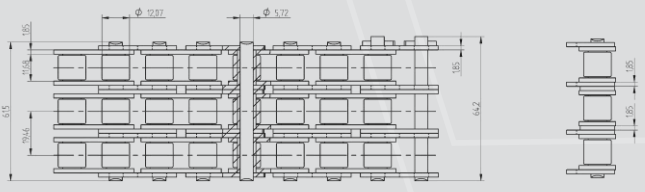
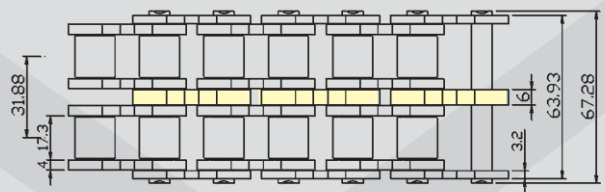

16B-1FVERZ93020505
16B-2FVERZ93020504

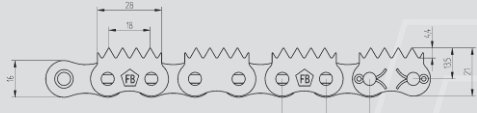

12B-3FBVERZAHNTS6/SO

edger

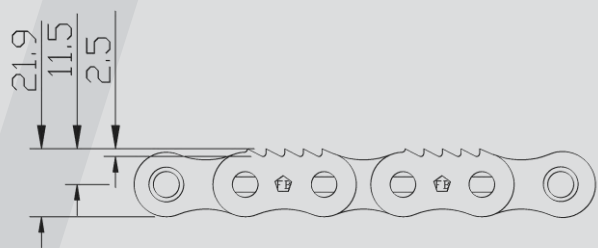
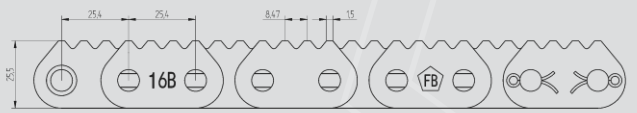
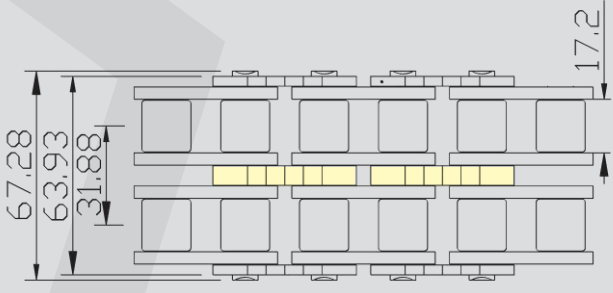

16B-2FB/95121221

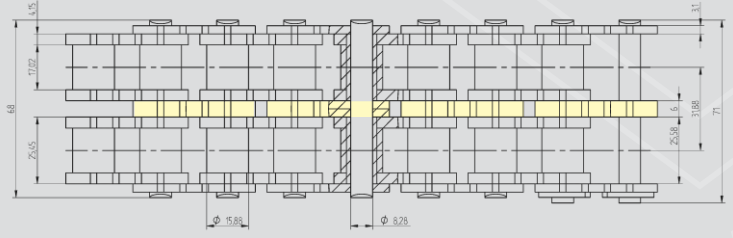

5118.000.35 ISO 16B-1 5218.000.1 16B-2 5318.000.07 ISO 16B-3

Other distance for sharp top link on request

IN STOCK!*

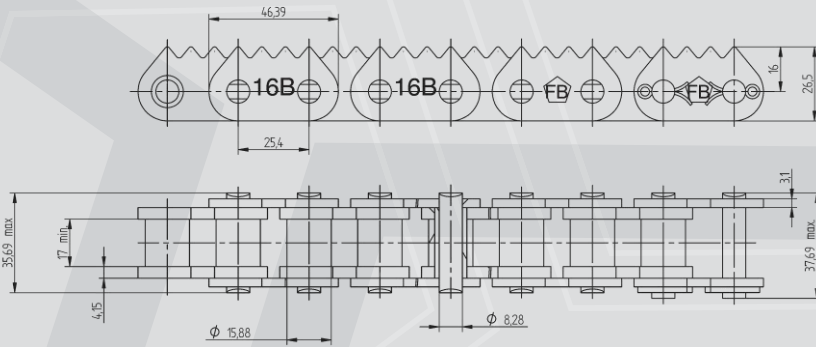

16B-1FBVERZAHNT

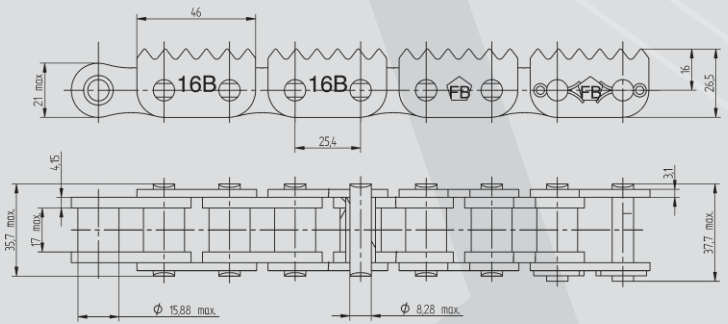
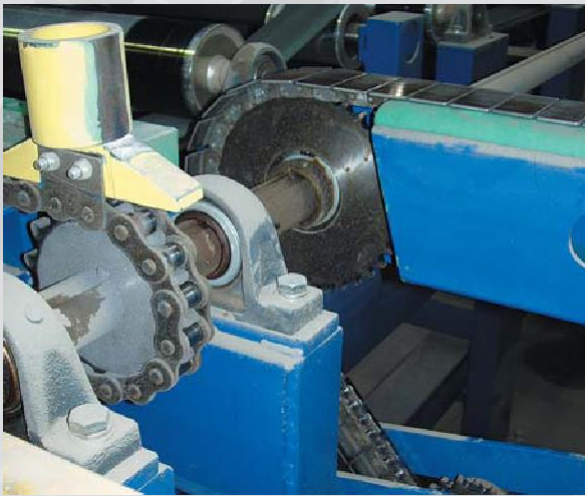
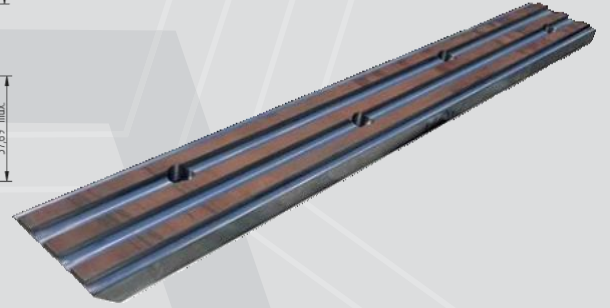

16B-1FBVERZAHNT6x50,8

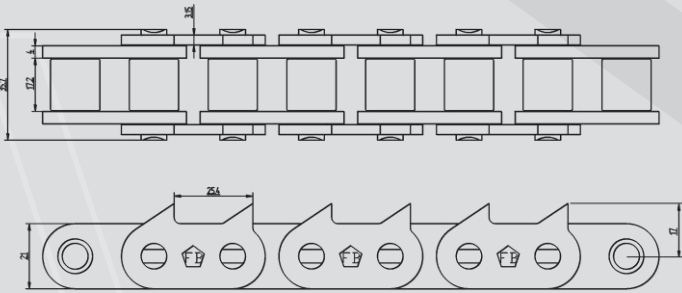

16B-1FBSÄGEVERZ2X50

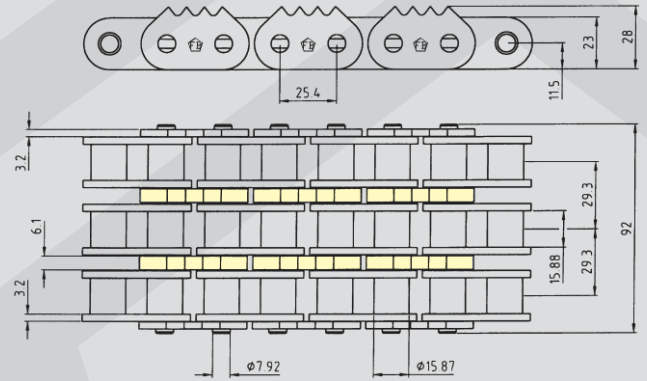

6118.000.03
6218.000.03
6318.000.01
ANSI 80

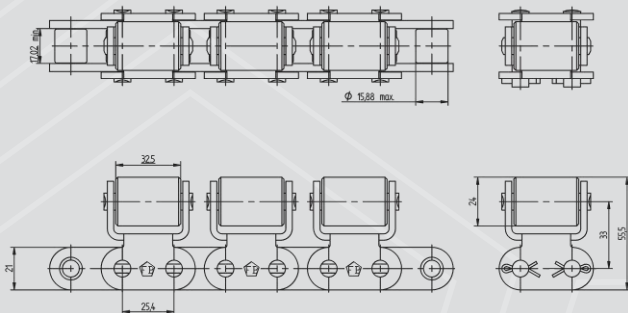

16B-1FBGL21/ROLLE32-97040904

Rubber top roller chains, roller chains with plastic parts

IN STOCK!*

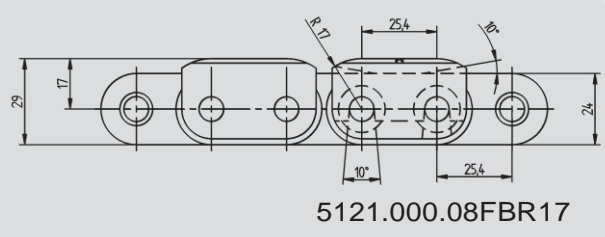
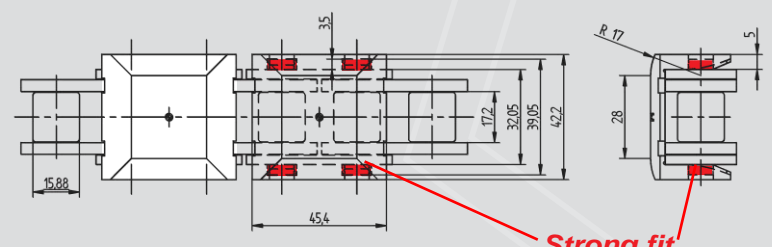
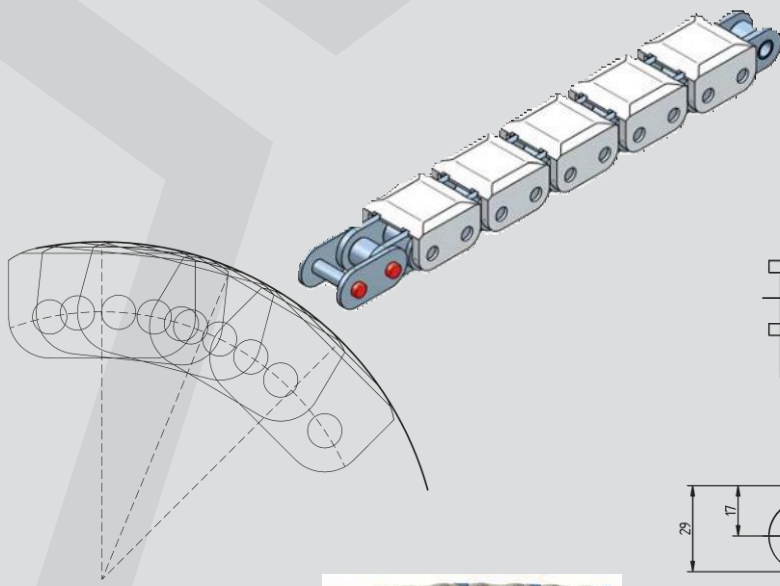
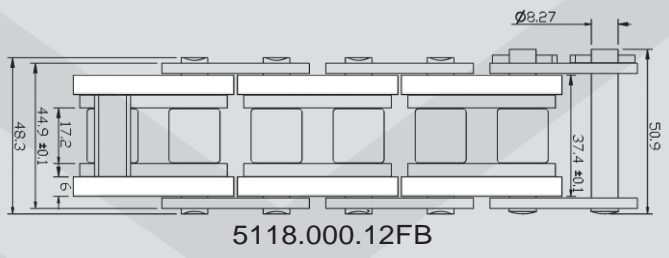
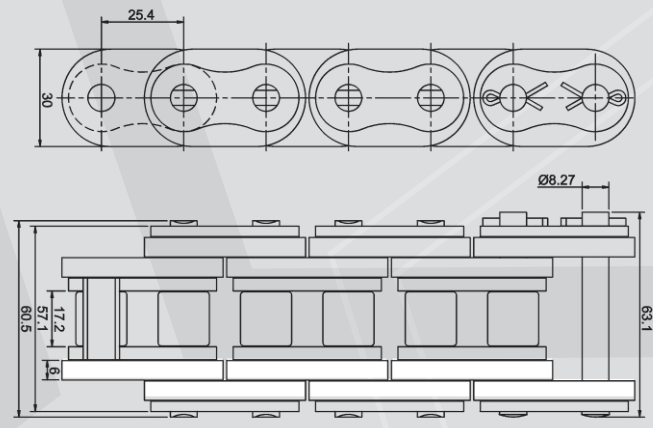
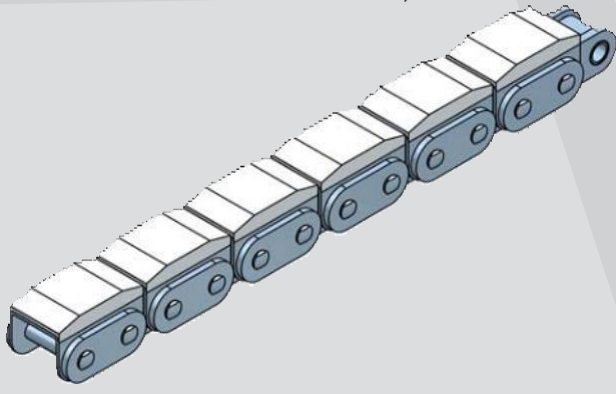
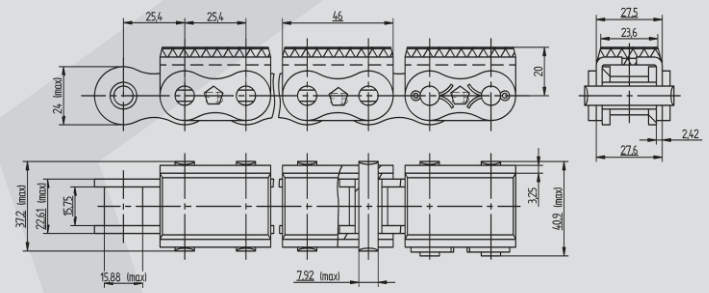
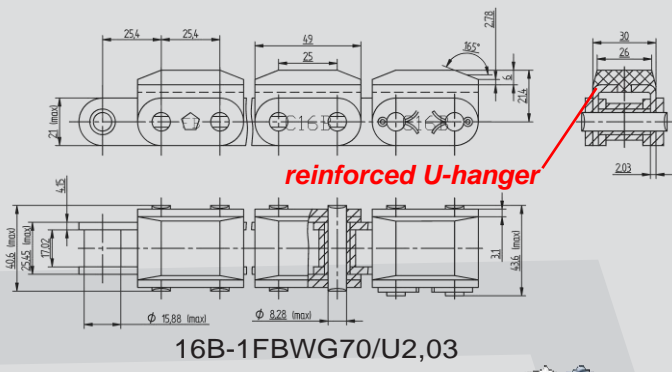

IN STOCK!*

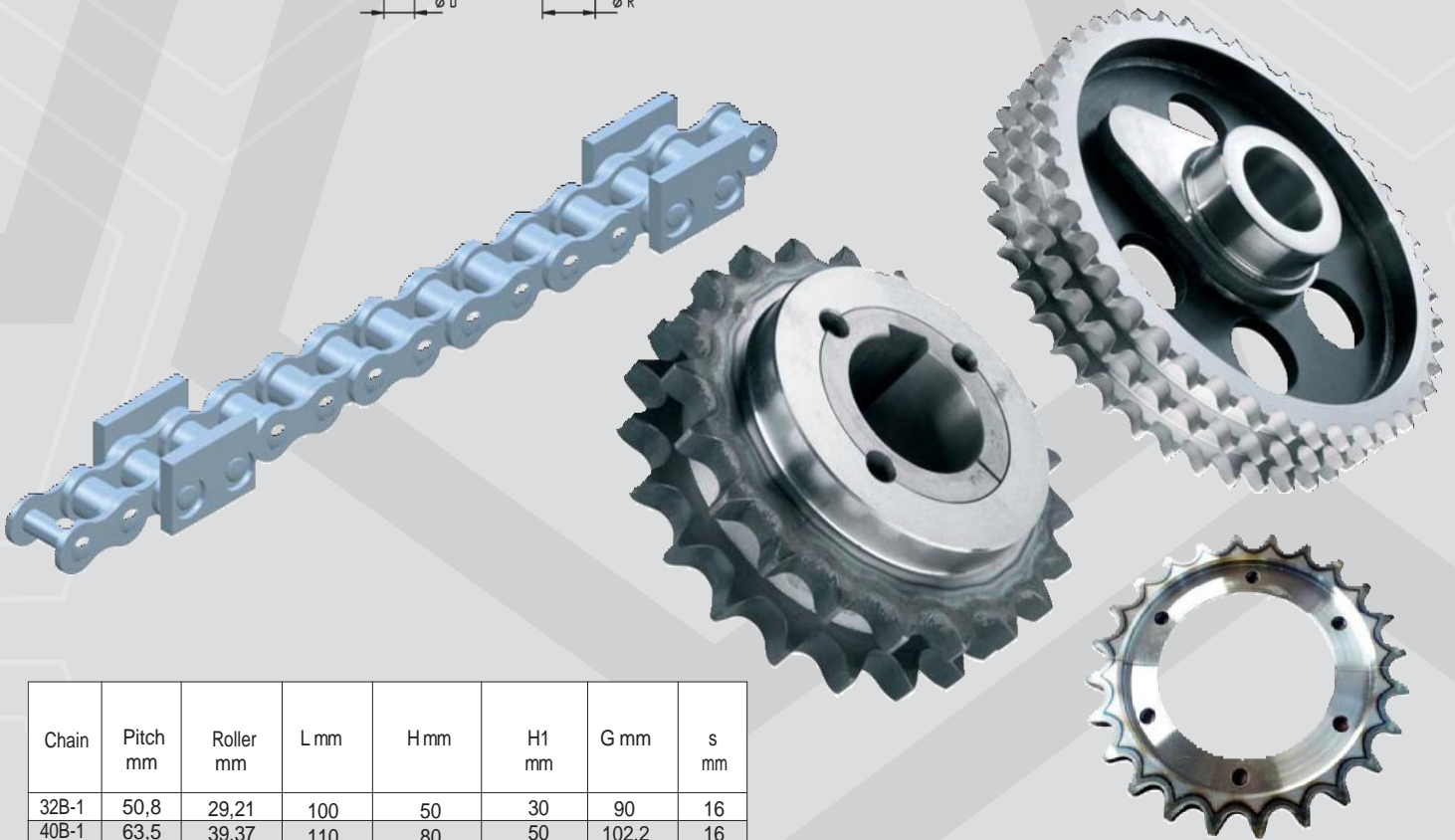
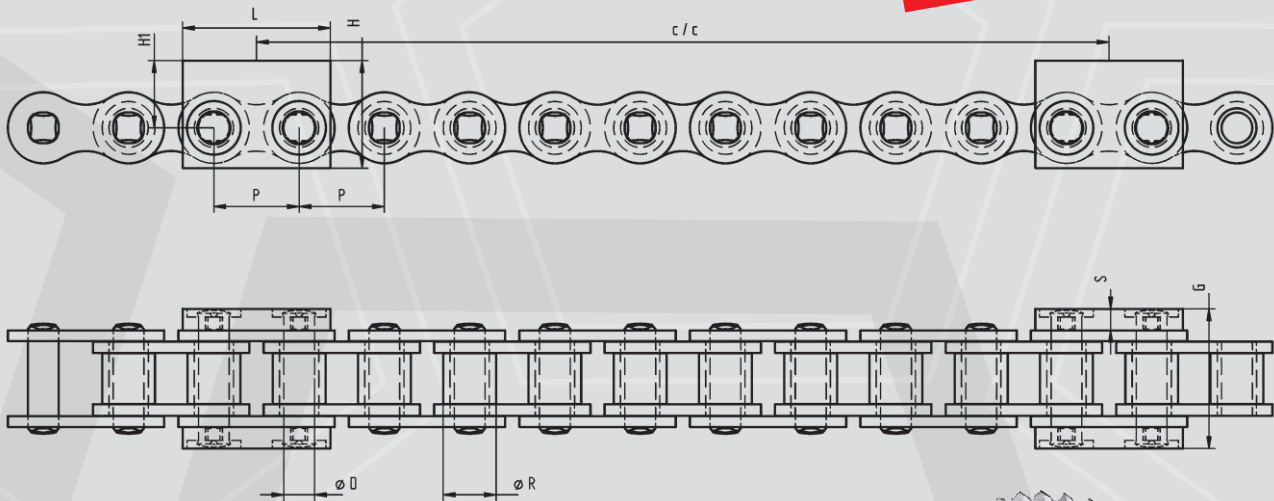

Chain	Pitch mm	Roller mm	L mm	H mm	H1 mm	G mm	s mm
32B-1	50,8	29,21	100	50	30	90	16
40B-1	63,5	39,37	110	80	50	102,2	16

Connecting links for Attachment Assembly

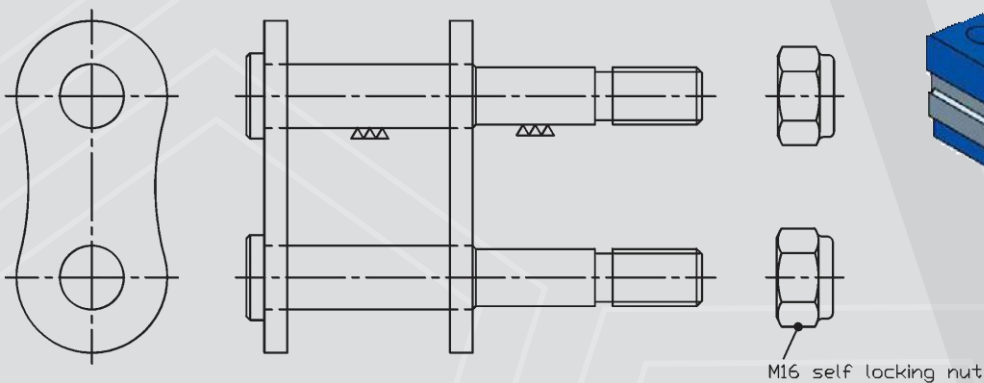

Other dimensions and design on request

FB leafchains

FB quality leaf chains are produced from high quality steels and are properly heat treated in modern ovens.

They offer high operational safety and low wear and higher fatigue strength than the benchmark.

Precise punching of sideplates and ball blasting increase the fatigue strength of FB leaf chains.

Grinded pins reduce wear and chain elongation.

FB leaf chains are dynamic prestreched to min. 30 % of their breaking load. This reduces initial chain elongation and avoids blocked components.

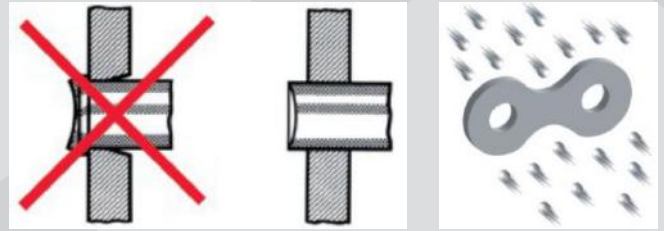

precise punched and ball blasted link plates

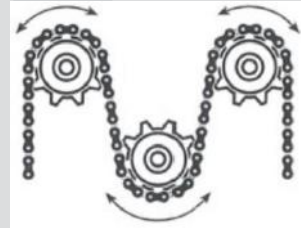

dynamic prestretching

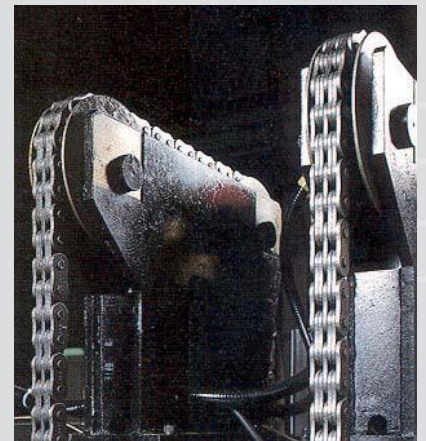

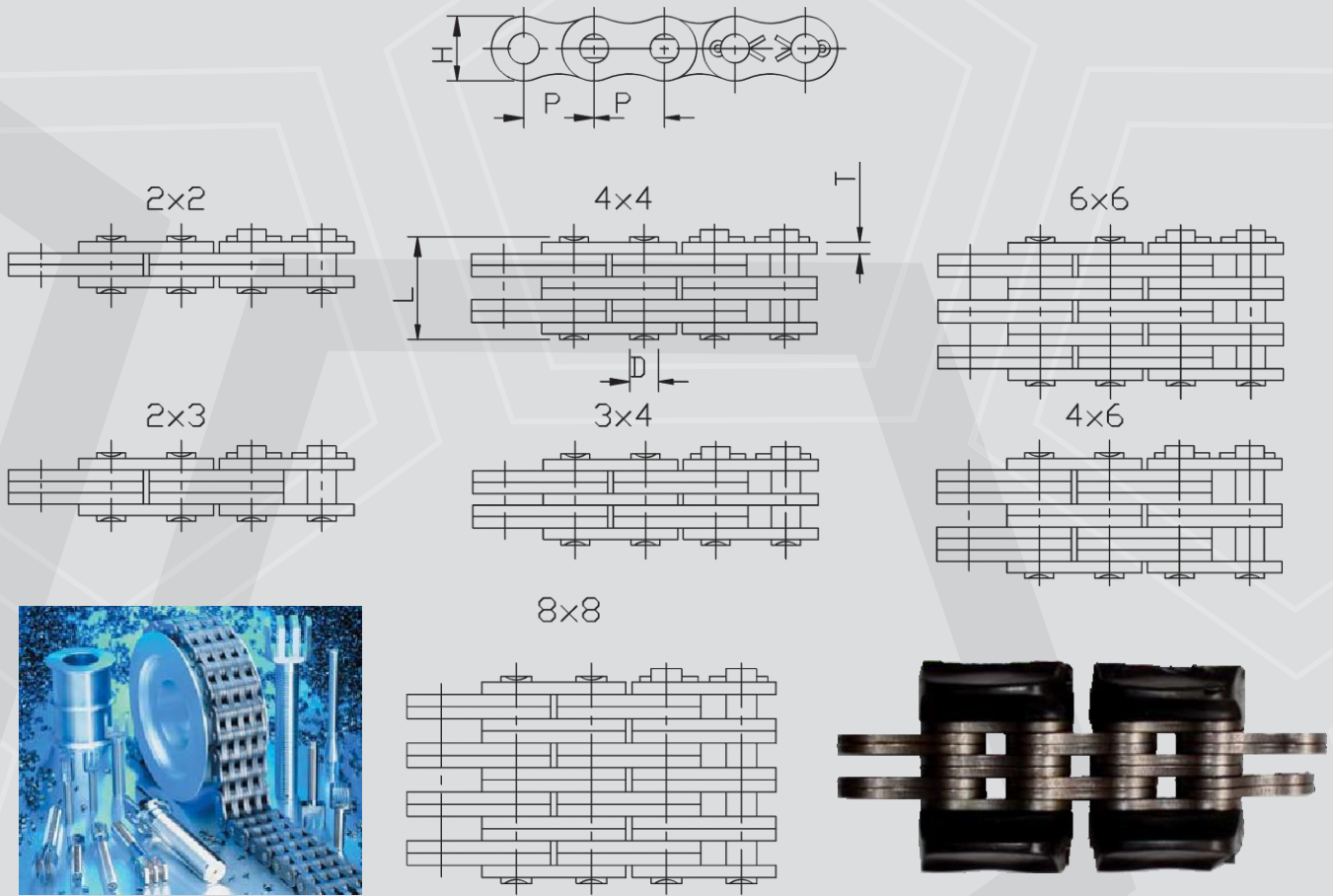

IN STOCK!*

ISO - DIN		Lacing	P		H	T	Pin		Breaking load		kg/m
			Inch	mm	mm	mm	Ø D mm	L mm	DIN (N)	FB (N) Ø	
LL0822	EL422	2x2	1/2"	12,70	10,20	1,50	4,44	8,25	17.800	17.800	0,36
LL0844	EL444	4x4	1/2"	12,70	10,20	1,50	4,44	14,50	36.400	36.400	0,69
LL0866	EL466	6x6	1/2"	12,70	10,20	1,50	4,44	20,75	54.600	54.600	1,05
LL1022	EL522	2x2	5/8"	15,875	13,00	1,65	5,06	9,00	22.200	25.506	0,50
LL1044	EL544	4x4	5/8"	15,875	13,00	1,65	5,06	15,90	44.500	51.012	1,00
LL1066	EL566	6x6	5/8"	15,875	13,00	1,65	5,06	22,77	66.700	78.480	1,48
LL1088	EL588	8x8	5/8"	15,875	13,00	1,65	5,06	29,60	88.900	103.986	1,95
LL1222	EL622	2x2	3/4"	19,05	16,00	1,80	5,72	10,10	28.900	39.240	0,74
LL1244	EL644	4x4	3/4"	19,05	16,00	1,80	5,72	17,70	57.800	65.000	1,45
LL1266	EL666	6x6	3/4"	19,05	16,00	1,80	5,72	25,30	86.700	97.000	2,16
LL1622	EL822	2x2	1"	25,40	20,80	3,20	8,27	16,65	58.000	78.480	1,57
LL1644	EL844	4x4	1"	25,40	20,80	3,20	8,27	30,05	116.000	156.960	3,09
LL1666	EL866	6x6	1"	25,40	20,80	3,20	8,27	43,10	174.000	235.440	4,60
LL2022	EL1022	2x2	1 1/4"	31,75	26,00	3,50	10,18	19,20	95.000	117.720	2,01
LL2044	EL1044	4x4	1 1/4"	31,75	26,00	3,50	10,18	34,00	190.000	235.440	3,93
LL2066	EL1066	6x6	1 1/4"	31,75	26,00	3,50	10,18	48,80	285.000	315.000	5,86
LL2088	EL1088	8x8	1 1/4"	31,75	26,00	3,50	10,18	63,60	380.000	470.880	8,20
LL2422	EL1222	2x2	1 1/2"	38,10	33,00	5,20	14,62	26,15	170.000	176.580	4,18
LL2444	EL1244	4x4	1 1/2"	38,10	33,00	5,20	14,62	47,95	340.000	353.160	8,48
LL2466	EL1266	6x6	1 1/2"	38,10	33,00	5,20	14,62	69,75	510.000	529.740	12,20
LL2488	EL1288	8x8	1 1/2"	38,10	33,00	5,20	14,62	91,55	680.000	706.320	16,00
LL2822	EL1422	2x2	1 3/4"	44,45	37,00	6,40	15,89	31,35	200.000	224.649	5,20
LL2844	EL1444	4x4	1 3/4"	44,45	37,00	6,40	15,89	57,95	400.000	448.317	10,10
LL2866	EL1466	6x6	1 3/4"	44,45	37,00	6,40	15,89	84,55	600.000	672.966	14,90
LL2888	EL1488	8x8	1 3/4"	44,45	37,00	6,40	15,89	111,15	800.000	896.634	19,80
LL3222	EL1622	2x2	2"	50,8	42,20	6,40	17,81	32,50	260.000	291.200	7,20
LL3244	EL1644	4x4	2"	50,8	42,20	6,40	17,81	58,50	520.000	582.400	12,86
LL3266	EL1666	6x6	2"	50,8	42,20	6,40	17,81	84,50	780.000	873.600	18,43
LL3288	EL1688	8x8	2"	50,8	42,20	6,40	17,81	110,70	1.050.000	1.176.000	25,37
LL3244FB(T6)	EL1644FB-6	4x4	2"	50,8	42,00	6,00	17,81	57,00	520.000	540.400	12,5
LL3266FB(T6)	EL1666FB-6	6x6	2"	50,8	42,00	6,00	17,81	110,00	1.050.000	1.080.800	25,0

FB leafchains heavy series LH (BL) – DIN8152-3

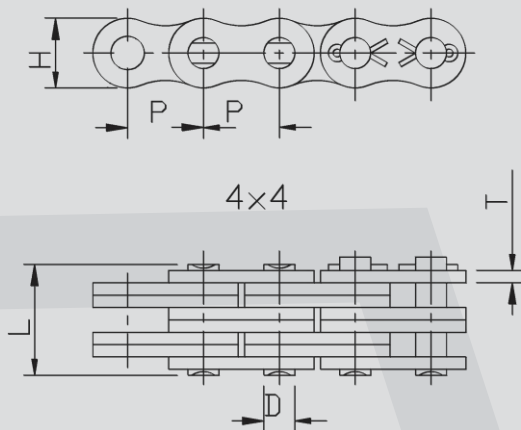

IN STOCK!*

	ISO -DIN	Lacing	P		H	T	Pin		Breaking load		kg/m
			Inch	mm	mm	mm	Ø D mm	L mm	DIN (N)	FB (N) Ø	
BL422	LH0822	2x2	1/2"	12,70	12,00	2,00	5,06	10,60	22.200	29.430	0,69
BL423	LH0823	2x3	1/2"	12,70	12,00	2,00	5,06	12,60	22.200	29.430	0,77
BL434	LH0834	3x4	1/2"	12,70	12,00	2,00	5,06	16,80	33.400	44.145	1,07
BL444	LH0844	4x4	1/2"	12,70	12,00	2,00	5,06	18,90	44.500	58.860	1,19
BL446	LH0846	4x6	1/2"	12,70	12,00	2,00	5,06	23,10	44.500	58.860	1,48
BL466	LH0866	6x6	1/2"	12,70	12,00	2,00	5,06	27,20	66.700	88.290	1,80
BL523	LH1023	2x3	5/8"	15,875	14,85	2,40	5,95	15,20	33.400	44.145	1,13
BL534	LH1034	3x4	5/8"	15,875	14,85	2,40	5,95	20,10	48.900	66.708	1,56
BL544	LH1044	4x4	5/8"	15,875	14,85	2,40	5,95	22,65	66.700	88.290	1,78
BL546	LH1046	4x6	5/8"	15,875	14,85	2,40	5,95	27,50	66.700	88.290	2,22
BL566	LH1066	6x6	5/8"	15,875	14,85	2,40	5,95	32,50	100.100	132.435	2,74
BL623	LH1223	2x3	3/4"	19,05	17,90	3,15	7,94	19,35	48.900	68.670	1,82
BL634	LH1234	3x4	3/4"	19,05	17,90	3,15	7,94	25,95	75.600	103.005	2,52
BL644	LH1244	4x4	3/4"	19,05	17,90	3,15	7,94	29,50	97.900	137.340	2,87
BL646	LH1246	4x6	3/4"	19,05	17,90	3,15	7,94	36,00	97.900	137.340	3,57
BL666	LH1266	6x6	3/4"	19,05	17,90	3,15	7,94	42,35	146.800	206.010	4,27
BL822	LH1622	2x2	1"	25,40	24,00	3,90	9,52	21,11	84.500	117.720	2,30
BL823	LH1623	2x3	1"	25,40	24,00	3,90	9,52	25,25	84.500	117.720	3,15
BL834	LH1634	3x4	1"	25,40	24,00	3,90	9,52	33,53	129.000	176.580	4,37
BL844	LH1644	4x4	1"	25,40	24,00	3,90	9,52	37,67	169.000	235.440	4,98
BL846	LH1646	4x6	1"	25,40	24,00	3,90	9,52	45,95	169.000	235.440	6,20
BL866	LH1666	6x6	1"	25,40	24,00	3,90	9,52	54,23	253.600	353.160	7,50
BL1023	LH2023	2x3	1 1/4"	31,75	30,10	4,70	11,10	29,70	115.600	156.960	3,85
BL1034	LH2034	3x4	1 1/4"	31,75	30,10	4,70	11,10	39,50	183.400	235.440	5,84
BL1044	LH2044	4x4	1 1/4"	31,75	30,10	4,70	11,10	44,40	231.300	313.920	7,20
BL1046	LH2046	4x6	1 1/4"	31,75	30,10	4,70	11,10	54,20	231.300	313.920	8,24
BL1066	LH2066	6x6	1 1/4"	31,75	30,10	4,70	11,10	64,00	347.000	470.880	10,63
BL1222	LH2422	2x2	1 1/2"	38,1	35,00	5,60	12,70	29,05	151.200	201.105	4,83
BL1223	LH2423	2x3	1 1/2"	38,1	35,00	5,60	12,70	34,85	151.200	201.105	6,54
BL1234	LH2434	3x4	1 1/2"	38,1	35,00	5,60	12,70	46,50	244.600	301.658	9,10
BL1244	LH2444	4x4	1 1/2"	38,1	35,00	5,60	12,70	52,30	302.500	402.210	10,39
BL1246	LH2446	4x6	1 1/2"	38,1	35,00	5,60	12,70	63,95	302.500	402.210	12,01
BL1266	LH2466	6x6	1 1/2"	38,1	35,00	5,60	12,70	75,60	453.700	603.315	14,58
BL1422	LH2822	2x2	1 3/4"	44,45	42,00	6,40	14,28	32,90	191.300	225.630	7,20
BL1423	LH2823	2x3	1 3/4"	44,45	42,00	6,40	14,28	39,40	191.300	225.630	9,05
BL1434	LH2834	3x4	1 3/4"	44,45	42,00	6,40	14,28	52,60	315.800	372.780	12,60
BL1444	LH2844	4x4	1 3/4"	44,45	42,00	6,40	14,28	59,30	382.600	451.260	14,41
BL1446	LH2846	4x6	1 3/4"	44,45	42,00	6,40	14,28	72,40	382.600	451.260	17,98
BL1466	LH2866	6x6	1 3/4"	44,45	42,00	6,40	14,28	85,70	578.300	676.890	21,52
BL1488	LH2888	8x8	1 3/4"	44,45	42,00	6,40	14,28	112,00	765.100	902.520	28,59
BL1622	LH3222	2x2	2"	50,80	48,00	7,20	17,45	36,70	289.100	343.350	9,72
BL1623	LH3223	2x3	2"	50,80	48,00	7,20	17,45	44,10	289.100	343.350	12,11
BL1634	LH3234	3x4	2"	50,80	48,00	7,20	17,45	59,70	440.400	539.550	16,86
BL1644	LH3244	4x4	2"	50,80	48,00	7,20	17,45	67,40	578.300	686.700	19,22
BL1646	LH3246	4x6	2"	50,80	48,00	7,20	17,45	82,55	578.300	686.700	23,92
BL1666	LH3266	6x6	2"	50,80	48,00	7,20	17,45	98,05	857.400	1.030.050	28,71
BL1688	LH3288	8x8	2"	50,80	48,00	7,20	17,45	128,40	1.156.500	1.373.400	38,19

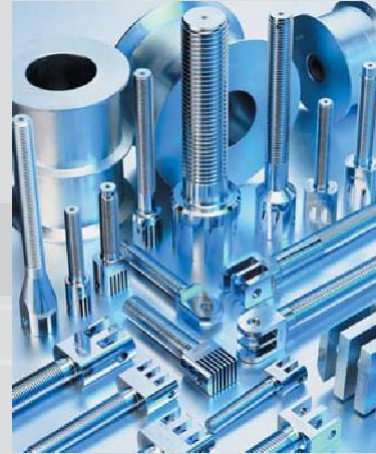

IN STOCK!*

ANSI	Lacing	P		H	T	Pin		Breaking load		kg/m
		Inch	mm	mm	mm	Ø D mm	L mm	DIN (N)	FB (N) Ø	
AL422	2x2	1/2"	12,70	10,20	1,50	3,96	8,05	15.000	17.658	0,36
AL444	4x4	1/2"	12,70	10,20	1,50	3,96	14,35	30.000	35.316	0,71
AL466	6x6	1/2"	12,70	10,20	1,50	3,96	20,70	45.000	52.974	1,22
AL522	2x2	5/8"	15,875	13,00	2,00	5,06	10,60	25.000	30.411	0,63
AL523	2x3	5/8"	15,875	13,00	2,00	5,06	12,70	25.000	30.411	0,78
AL544	4x4	5/8"	15,875	13,00	2,00	5,06	19,00	50.000	60.822	1,23
AL566	6x6	5/8"	15,875	13,00	2,00	5,06	27,40	75.000	91.233	2,10
AL588	8x8	5/8"	15,875	13,00	2,00	5,06	35,85	100.000	121.644	2,46
AL622	2x2	3/4"	19,05	15,50	2,35	5,95	12,40	34.000	44.145	0,90
AL623	2x3	3/4"	19,05	15,50	2,35	5,95	14,85	34.000	44.145	1,12
AL644	4x4	3/4"	19,05	15,50	2,35	5,95	22,30	68.000	88.290	1,78
AL646	4x6	3/4"	19,05	15,50	2,35	5,95	27,30	68.000	88.290	2,25
AL666	6x6	3/4"	19,05	15,50	2,35	5,95	33,25	102.000	132.435	3,03
AL688	8x8	3/4"	19,05	15,50	2,35	5,95	42,20	136.000	176.580	3,60
AL822	2x2	1"	25,40	20,40	3,10	7,94	15,65	59.000	76.518	1,48
AL844	4x4	1"	25,40	20,40	3,10	7,94	28,45	118.000	153.036	2,92
AL866	6x6	1"	25,40	20,40	3,10	7,94	41,25	177.000	229.554	4,97
AL888	8x8	1"	25,40	20,40	3,10	7,94	54,05	236.000	306.072	5,78
AL1022	2x2	1 1/4"	31,75	24,80	3,90	9,52	21,11	86.000	117.720	2,35
AL1044	4x4	1 1/4"	31,75	24,80	3,90	9,52	37,67	172.000	235.440	4,61
AL1066	6x6	1 1/4"	31,75	24,80	3,90	9,52	54,23	258.000	353.160	7,88
AL1088	8x8	1 1/4"	31,75	24,80	3,90	9,52	70,79	344.000	470.880	9,23
AL1222	2x2	1 1/2"	38,10	30,00	4,70	11,10	24,60	122.500	156.960	3,40
AL1244	4x4	1 1/2"	38,10	30,00	4,70	11,10	44,20	245.000	313.920	6,65
AL1266	6x6	1 1/2"	38,10	30,00	4,70	11,10	63,80	367.500	470.880	10,14
AL1444	4x4	1 3/4"	44,45	36,20	5,60	12,7	52,30	309.000	402.210	10,34
AL1466	6x6	1 3/4"	44,45	36,20	5,60	12,7	75,60	463.500	608.220	15,16
AL1644	4x4	2"	50,80	41,40	6,40	14,28	59,55	390.000	539.550	12,98
AL1666	6x6	2"	50,80	41,40	6,40	14,28	86,15	585.000	804.420	19,41
AL1688	8x8	2"	50,80	41,40	6,40	14,28	112,75	780.000	1.079.100	25,84

FB chain wear gauge for leafchain and roller chain



Drop forged link chains

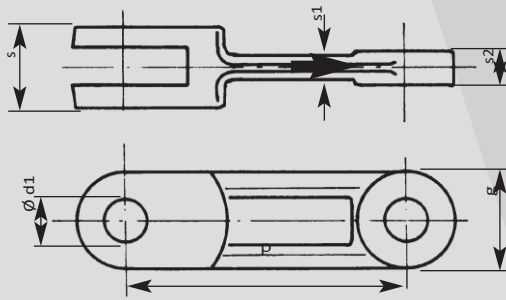

Style A

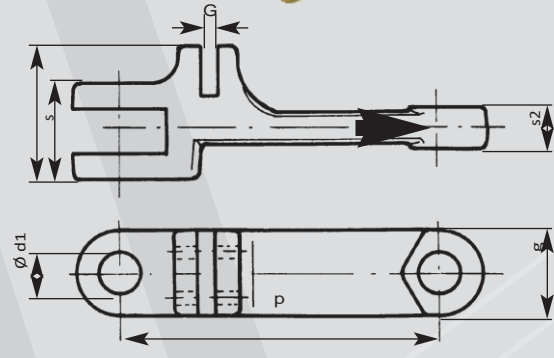

Style D

Chain	Style	p mm	s mm	s ₁ mm	s ₂ mm	g mm	G mm	d ₁ mm	Breaking Load (kN) min.				kg/m
									20MnCr5 CH	18NiCrMo5 CH	C40 TH	42CrMo4 TH	
R100101	A	101,60	24	6	8	36		14	90	95	100	130	3,85
R100102	A	101,60	30	8	12	36		14	120	130	150	200	5,25
R200101	A	102,00	25	6	8	36		14	75	85	90	120	3,95
R100103	A	142,00	24	6	8	47		20	110	120	145	200	4,50
R100104	A	142,00	42	11	19	50		25	270	280	350	440	10,40
R100105	A	142,00	62	15	28	50		25	370	400	500	600	14,90
R200102	A	142,00	56	18	25	50		25	310	350	400	480	12,50
R100106	A	150,00	24	6	8	50		20	110	120	145	200	5,00
R100107	A	150,00	42	12	15,5	47		25	230	250	300	340	10,00
R100108	A	160,00	50	12	23	50		25	300	320	400	520	10,50
R200103	A	160,00	42	12	20	45		20	260	275	320	380	11,00
R200104	F	160,00	72	15	22	45		22	270				14,50
R300175	D	175,00	72	22	30	60	11	30	500	550	600	710	15,00
R100109	A	200,00	66	17	32	60		28	530	580	650	750	16,30
R200105	A	200,00	54	15	25,5	50		25	310	350	400	480	12,80
R200106	D	200,00	52	18	25	50	13	25	300	340	330	460	11,50
R200107	D	200,00	58	17	25	50	11,5	25	310	350	450	550	13,00
R200108	D	200,00	70	20	30	60	13	30	500	550	600	750	19,40
R300216	A	216,00	64	20	26	73		35	480	500	630	700	20,00
R200109	F	220,00	96	20	28	66		32	530	568	650	750	23,00
R100110	A	250,00	70	20	31	75		34	600	650	750	1.000	24,00
R200110	A	250,00	66	18	33	60		28	530	580	650	750	14,00
R200111	D	250,00	70	20	30	60	13	30	500	550	600	700	16,00
R200112	E	250,00	86	20	43	80		40	850	880	950	1.100	39,00
R100111	A	260,00	70	21	31	75		34	600	650	750	1.000	21,65

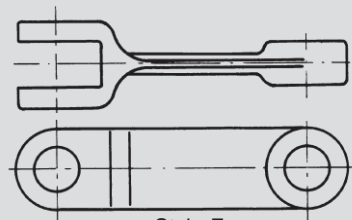

Style E

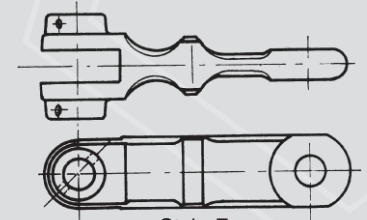

Style F

Calculated breaking load
 Tested breaking load
 new tooling necessary

Other materials, dimension and design on request

Heat treatment

CH ... case hardened

TH ... through hardened (hardened and tempered)

**Symmetric teeth optimal
= double life time**

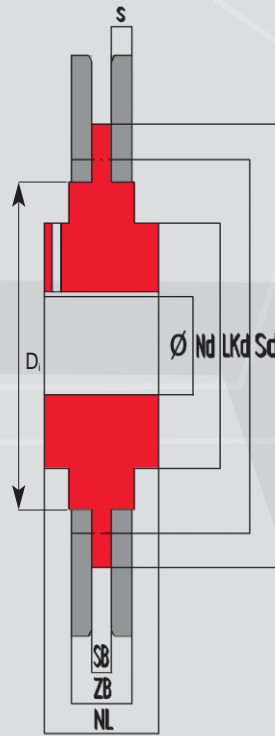
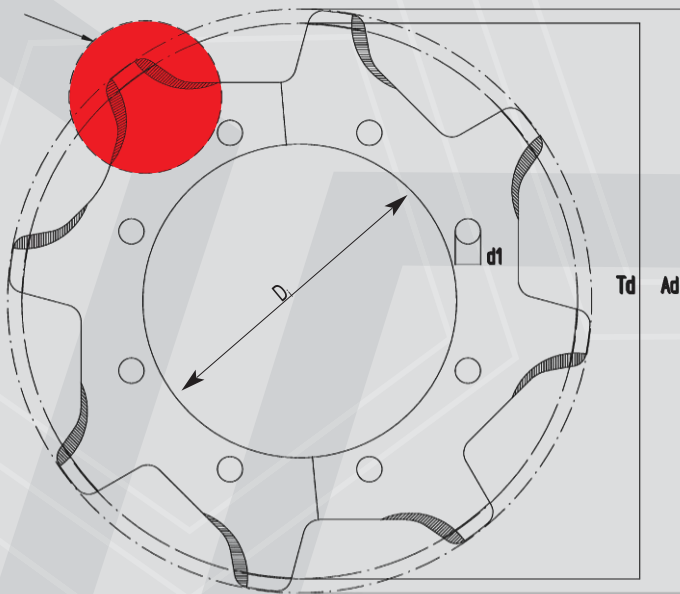

Optimized tooth design

Teeth	Ad	Td	R100104 – T142N - 14218			R100105 – T142H - 14226			Sd mm	d1 mm	screws	Kg /pce
	mm	mm	ZB (mm)	SB (mm)	s (mm)	ZB (mm)	SB (mm)	s (mm)				
6	304	284,00	46	16	15	64	24	20	192	17	6 x M16	22
7	344	327,31	46	16	15	64	24	20	233	17	7 x M16	33
8	390	371,06	46	16	15	64	24	20	280	17	8 x M16	47
9	434	415,18	46	16	15	64	24	20	330	17	9 x M16	68
10	474	459,52	46	16	15	64	24	20	368	17	10 x M16	82
11	534	504,02	46	16	15	64	24	20	420	17	11 x M16	101
12	564	548,64	46	16	15	64	24	20	466	17	12 x M16	130
13	615	593,37	46	16	15	64	24	20	512	17	13 x M16	176
14	660	638,15	46	16	15	64	24	20	558	17	14 x M16	220
15	702	682,87	46	16	15	64	24	20	603	17	15 x M16	251
16	750	727,90	46	16	15	64	24	20	650	17	16 x M16	349

56HRC Eht 2-3mm



for.... teeth	Return rollers (idlers)			kg/pce
	Dm mm	B mm		
		R100104	R100105	
6	235	50	70	15
7	280	50	70	23
8	320	50	70	29
9	365	50	70	41
10	410	50	70	50
11	450	50	70	68
12	500	50	70	84
13	540	50	70	88
14	590	50	70	100
15	630	50	70	126
16	680	50	70	151



Our chain solutions increase your profit

In 1908 we started to produce conveyor chains, sharp top chains, roller chains and leaf chains in Eskilstuna (Sweden). Today we produce our conveyor chains in our factory in Lappi Rauma (Finland) which was opened in 2019. FB companies are part of the Swedish ADDTECH-group.

We are the technology and market leader in European sawmills and biomass power plants and know most of the chain-applications by heart.

We produce chains according to international standards and are very strong in customized chains according to drawings or samples.

But we do not only replace chains, we prefer to optimize existing chain solutions and make them work more profitable. Our goal is to increase conveyor up-uptime, profitability and the operational security by through longer lifetime of chains, sprockets and chain rails.

In Austria, Germany, Sweden, Finland and UK we stock conveyor chains according to DIN8165 and DIN8167 (ISO1977), roller chains ISO606 (DIN8187, DIN8188), sharp top chains, roller chains with plastic attachments or rubber top, leaf chains and many customized chains which are very common in wood & wood processing, biomass power plants and chip board factories.

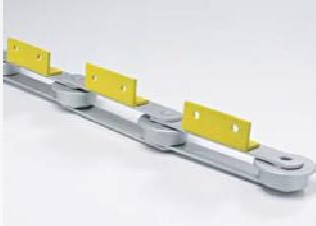
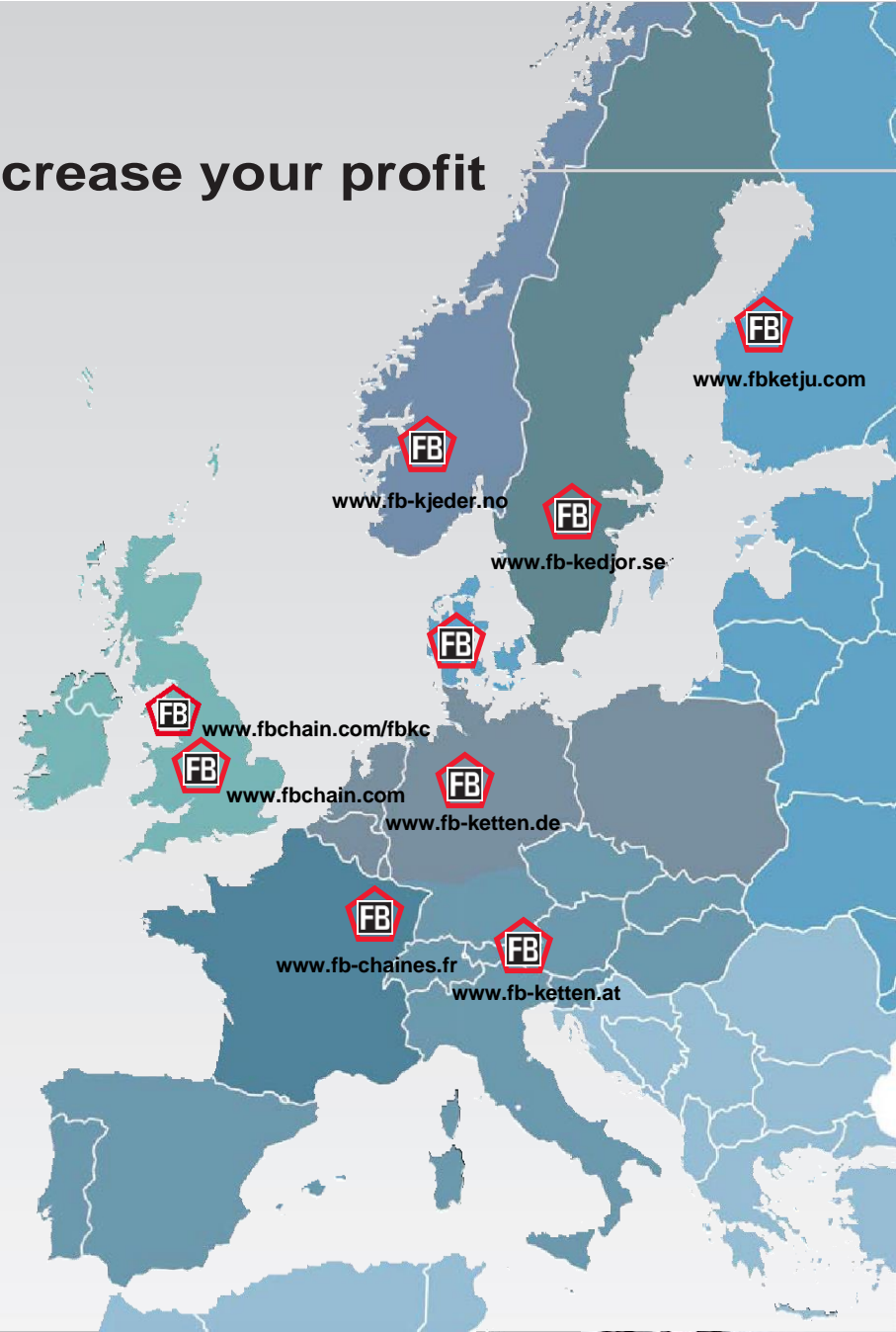

**FB Ketten
Handelsgesellschaft mbH.**

Gewerbepark Süd 5
A 6330 Kufstein
Tel. +43 (0)5372 61466
Fax +43 (0)5372 61466-20
fbketten@fb-ketten.com

We make your chain applications more profitable